

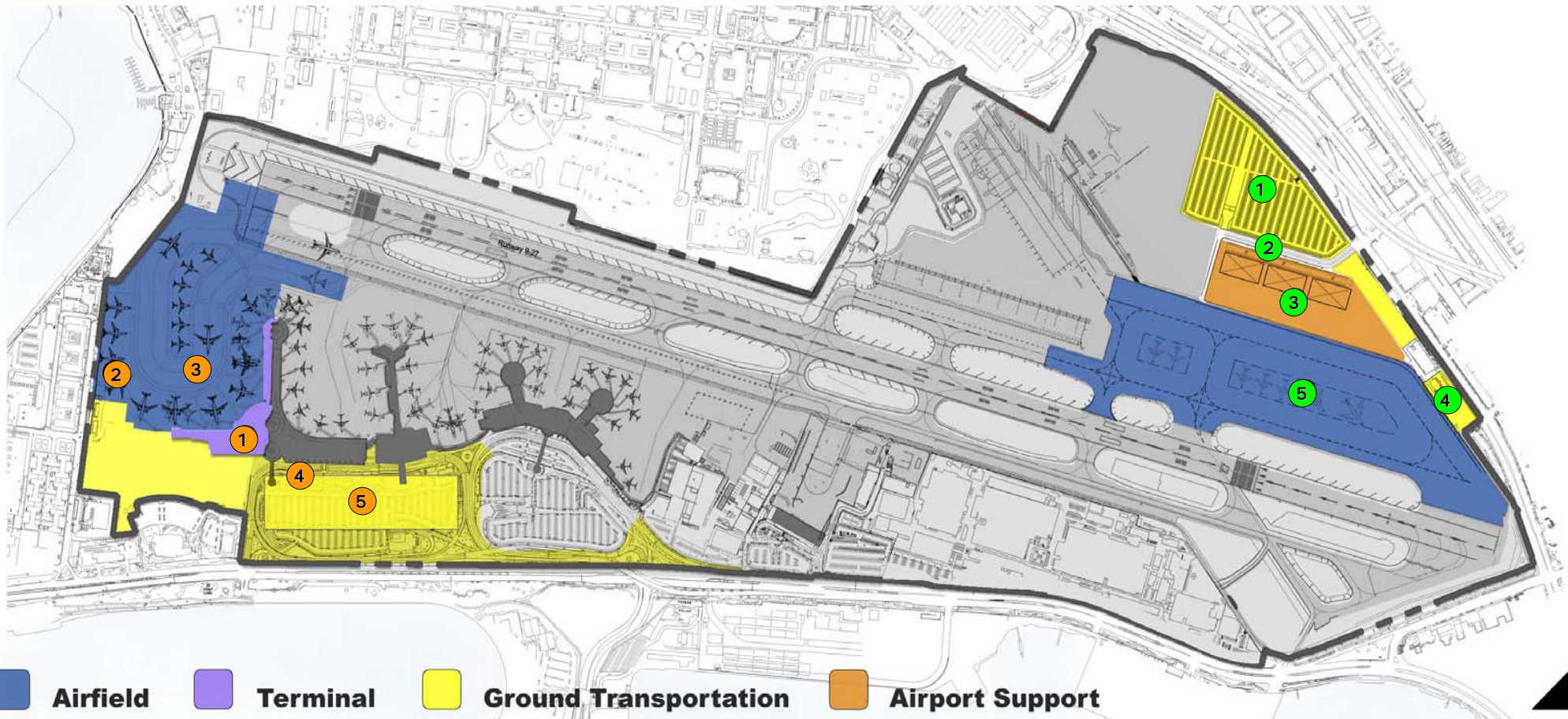

AIRPORT MASTER PLAN  
SAN DIEGO INTERNATIONAL AIRPORT

# Airport Implementation Plan



## Project Elements

- |   |  |  |  |
|---|--|--|--|
| <ul style="list-style-type: none"> <li><b>1</b> Expand existing Terminal 2 West with 10 new jet gates</li> <li><b>2</b> Construct new aircraft parking and replacement Remain-Over-Night (RON) aircraft parking apron</li> <li><b>3</b> Construct new apron and aircraft taxiway</li> </ul> | <ul style="list-style-type: none"> <li><b>4</b> Construct new second level road/curb and vehicle circulation</li> <li><b>5</b> Construct a new parking structure and vehicle circulation serving Terminal 2</li> </ul> | <ul style="list-style-type: none"> <li><b>1</b> Relocate and reconfigure SAN Park Pacific Highway</li> <li><b>2</b> Construct a new access road to North Area facilities from Sassafras St./ Pacific Highway intersection</li> <li><b>3</b> Construct new general aviation facilities including access, terminal/hangars, and apron on 12.4 acres</li> </ul> | <ul style="list-style-type: none"> <li><b>4</b> Demolish the existing general aviation facilities</li> <li><b>5</b> Reconstruct Taxiway C and construct new apron hold pads and new Taxiway east of Taxiway D</li> </ul> |
|---|--|--|--|



AIRPORT MASTER PLAN  
SAN DIEGO INTERNATIONAL AIRPORT

# Airport Implementation Plan Alternative



■ **Airfield**   
 ■ **Terminal**   
 ■ **Ground Transportation**   
 ■ **Airport Support**



## Project Elements

- |  |  |  |  |
|--|--|--|--|
| <ul style="list-style-type: none"> <li><b>1</b> Construct new unit terminal with 5 replacement gates and 7 new gates</li> <li><b>2</b> Expand existing Terminal 2 West with 3 new jet gates</li> <li><b>3</b> Relocate commuter aircraft to Terminals 1 and 2</li> <li><b>4</b> Construct new aircraft parking and replacement Remain-Over-Night (RON) aircraft parking apron</li> </ul> | <ul style="list-style-type: none"> <li><b>5</b> Construct new apron and aircraft taxiway</li> <li><b>6</b> Construct new surface parking and vehicle circulation west of Terminal 2 West</li> <li><b>7</b> Construct new surface and structured parking and vehicle circulation at Terminal 1 and new unit terminal</li> </ul> | <ul style="list-style-type: none"> <li><b>1</b> Relocate and reconfigure SAN Park Pacific Highway</li> <li><b>2</b> Construct a new access road to North Area facilities from Sassafras St./ Pacific Highway intersection</li> <li><b>3</b> Construct new general aviation facilities including access, terminal/hangars, and apron on 12.4 acres</li> </ul> | <ul style="list-style-type: none"> <li><b>4</b> Demolish the existing general aviation facilities</li> <li><b>5</b> Reconstruct Taxiway C and construct new apron, hold pads, and new taxiway east of Taxiway D</li> </ul> |
|--|--|--|--|