

SAN DIEGO COUNTY REGIONAL AIRPORT AUTHORITY

SPECIAL AIRPORT ART ADVISORY COMMITTEE

AGENDA

Tuesday, May 3, 2016
3:30 p.m.

San Diego International Airport
SDCRAA Administration Building -- Third Floor
Board Room
3225 N. Harbor Drive
San Diego, CA 92101

Board Members

Robert H. Gleason
Board Chair

David Alvarez
C. April Boling
Greg Cox
Jim Desmond
Lloyd B. Hubbs
Jim Janney
Paul Robinson
Mary Sessom

Ex-Officio Board Members

Laurie Berman
Eraina Ortega
Col. Jason G. Woodworth

President / CEO

Thella F. Bowens

This Agenda contains a brief general description of each item to be considered. If comments are made to the Committee without prior notice, or are not listed on the Agenda, no specific answers or responses should be expected at this meeting pursuant to State law.

Copies of written documentation relating to each item of business on the Agenda are on file in the Airport Authority's office and are available for public inspection.

PLEASE COMPLETE A "REQUEST TO SPEAK" FORM PRIOR TO THE COMMENCEMENT OF THE MEETING AND SUBMIT IT TO THE LIAISON OF THE COMMITTEE.

The Authority has identified a local company to provide oral interpreter and translation services for public meetings. If you require oral interpreter or translation services, please telephone the Corporate & Information Governance /Authority Clerk Department with your request at (619) 400-2400 at least three (3) working days prior to the meeting.

CALL TO ORDER

PLEDGE OF ALLEGIANCE

ROLL CALL

Committee Members: Bob Bolton, Ben Fyffe, Indra Gardiner, Robert H. Gleason, Diana Lucero, Chike Nwoffiah, Gail Roberts, Michael Soriano, Deborah Van Huis

NON AGENDA PUBLIC COMMENT:

Non-Agenda Public Comment is reserved for members of the public wishing to address the Committee on any matter for which another opportunity to speak **is not provided on the Agenda**, and which is within the jurisdiction of the Committee. Please submit a completed speaker slip to the Clerk of the Committee. *Each individual speaker is limited to three (3) minutes.*

NEW BUSINESS:

1. ACTION – APPROVAL OF MINUTES:

RECOMMENDATION: Approve the minutes from the March 11, 2016 meeting.

2. ACTION – APPOINT ARTIST SELECTION PANEL MEMBERS:

RECOMMENDATION: Appoint three qualified panelists and one committee liaison to review respondent submissions for the Parking Plaza Lobby Stair Public Art Opportunity.

3. PRESENTATION – PARKING PLAZA PUBLIC ART PROJECT:

Presented by: Gaston Nogues, Ball-Nogues Studio, LLC

OLD BUSINESS

4. STAFF UPDATES:

- Public Art
- Temporary Exhibitions
- Performing Arts Program
- Master Planning Process
- AAC Meeting Dates

COMMITTEE MEMBER COMMENTS

Each committee member speaker is limited to five (5) minutes.

ADJOURNMENT

NOTE: Members of the public wishing to address the Committee on Agenda Items must submit a speaker slip to the Liaison of the Committee. When called to speak, please state your name and city of residence for the record. Each speaker is limited to three (3) minutes per Agenda Item.

This information is available in alternative formats upon request. To request an Agenda in an alternative format, or to request a sign language or oral interpreter, or an Assistive Listening Device (ALD) for the meeting, please telephone the Authority Clerk's Office at (619) 400-2400 at least three (3) working days prior to the meeting to ensure availability.

For your convenience, the agenda is also available to you on our website at www.san.org.

DRAFT
 SAN DIEGO COUNTY REGIONAL AIRPORT AUTHORITY
 ART ADVISORY COMMITTEE (AAC)
 MEETING MINUTES: FRIDAY, MARCH 11, 2016
 SAN DIEGO COUNTY REGIONAL AIRPORT AUTHORITY ADMINISTRATION BUILDING
 BOARD ROOM, 3RD FLOOR

CALL TO ORDER: AAC Chair Deborah Van Huis called the meeting of the Art Advisory Committee to order at 9:02 a.m. on Friday, March 11, 2016, at San Diego International Airport, Administration Building Board Room, 3225 N. Harbor Drive, San Diego, CA 92101.

ROLL CALL

AAC Members Present:

Ben Fyffe	Cultural Programs Supervisor, City of El Paso Museums & Cultural Affairs
Indra Gardiner	Founder/Chief Influence Officer, i.d.e.a.
Robert H. Gleason	Board Chair, Airport Authority
Diana Lucero	Director, Vision, Voice & Engagement, Airport Authority
Chike Nwoffiah	Executive Director, Oriki Theater
Deborah Van Huis	Owner, Expertise on Demand

AAC Members Absent:

Bob Bolton	Director, Airport Design and Construction
Michael Soriano	Owner, Onairos Design

Airport Authority Staff Present:

Chris Chalupsky	Senior Manager, Art & Community Partnerships
Karla Cook	Art Program Coordinator I
Lauren Lockhart	Art Program Manager
Tony Russell	Director, Corporate & Information Governance/Authority Clerk

PLEDGE OF ALLEGIANCE: Chair Van Huis led the pledge of allegiance.

NEW BUSINESS:

1. **ACTION - APPROVAL OF MINUTES:** Committee Member Robert Gleason moved to approve the minutes of the January 27, 2016 meeting. The Motion was seconded by Committee Member Indra Gardiner. **Motion Passed unanimously.**
2. **PRESENTATION - RENTAL CAR CENTER DAZZLE PUBLIC ART PROJECT:** Nik Hafermaas of Ueberall International, LLC gave an overview of *Dazzle*. Gardiner inquired about the appearance of the tiles at night. Hafermaas shared that the tiles can be programmed at night to appear white or black when there is no direct sunlight to power them. He added that the current ambient light will expose the tiles at night, and that nighttime programming has yet to be determined. Hafermaas agreed to contact the lighting designer to coordinate with them. Committee Member Ben Fyffe inquired about the current landscaping's impact on the artwork. Lockhart and the artist team agreed to research anticipated future growth of the existing landscape. Gleason inquired about the management of the artwork. Lockhart explained that the programming will be fixed, but that adjustments can be made by the artist team as needed. Gardiner asked Committee Member Diana Lucero if outreach efforts will be made to explain the technology. Lucero shared that a dedication event will be held and that Art Program staff will continue to explain the technology during public

presentations. Gleason inquired about the schedule of the project. Lockhart confirmed that the artist team is on schedule to complete the installation at the end of this year.

3. **PRESENTATION - PALM STREET PARK PUBLIC ART PROJECT:** Murray Legge of Legge Lewis Legge, LLC gave an overview of the Palm Street Park Public Art Project. Fyffe inquired about the ADA compliance at the vista area. Legge shared that the team would consider incorporating a railing with a transparent appearance. Fyffe inquired about trash and recycling receptacles at the park. Lockhart informed the committee that the Authority is planning to build a concession at the site of the former World Trade Center located adjacent to the park and anticipates that this project will resolve the issue of trash and recycling receptacles. Committee members discussed the merits and challenges of Legge's geometrically organized pathway design, grading and slope in regards to an irrigation system, and acquisition of dirt for the project. Gardiner inquired about whether the artist team is considering the airport's commitment to LEED certification. Lockhart confirmed that the park design will feature sustainable elements and that the team is considering seeking SITES certification. Gleason praised the progress and design of the project thus far. Chair Van Huis echoed Gleason's positive comments. Gleason inquired about the project's schedule. Lockhart shared that the project will be completed mid to late 2017 and that she will inquire about a timeline for a construction contract and inform the committee at the next meeting.

OLD BUSINESS

4. STAFF UPDATES:

— **Public Art:**

- Rental Car Center Public Art Projects: Lockhart announced a public art dedication event from 5:00 - 6:30 p.m. on Thursday, April 28 in honor of Christian Moeller and Amy Landesberg's recently completed installations.

— **Temporary Exhibitions:**

- *Point of Entry*: Lockhart presented 14 recent installations in the 2016 temporary exhibition *Point of Entry*.

— **Performing Arts Program:**

- Chris Chalupsky informed the committee that the airport's existing contract with a Production Specialist will end on June 30. A Request for Qualifications will be released in the near future. He also shared that performances will increase in frequency.

— **Master Planning Process**

- Chalupsky informed the committee that he is currently researching Art Master Plans and potential consultants.

OLD BUSINESS:

None

COMMITTEE MEMBER REPORTS/ COMMENTS:

None

ADJOURNMENT: The meeting was adjourned at 10:16 a.m.

APPROVED BY A MOTION OF THE AIRPORT ART ADVISORY COMMITTEE MEETING ON THE THIRD DAY OF MAY, 2016.

LAUREN LOCKHART
ART PROGRAM MANAGER



ARRIVE, DEPART,
BE INSPIRED.

**Parking Plaza Lobby Stair Public Art Project
Recommended Artist Selection Panel**

David A. Adey, Artist

David A. Adey graduated from PLNU in 1994 with a B.A. in Visual Art. Beginning his career in graphic design, specializing in package design and illustration, he worked for companies in New York and New Jersey, and then returned to San Diego where he joined the branding agency Mires+Ball Inc. In 2002, David received his M.F.A. in sculpture from Cranbrook Academy of Art in Michigan. His work was exhibited in the 2010 California Biennial at the Orange County Museum of Art, the Museum of Contemporary Art San Diego, Torrance Art Museum, and the University of Nevada, Las Vegas, as well as numerous other exhibitions in San Diego, Los Angeles, Detroit, Boston and Miami. He is represented by Scott White Contemporary Art in La Jolla, CA and Luis De Jesus Los Angeles in Culver City, CA. Adey is a faculty member at Point Loma Nazarene University.

Anne Marie Purkey Levine, Independent Consultant

Anne Marie has over 15 years of fine art collection and exhibition management experience, with a focus in contemporary art and more recently in public art. She empowers arts organizations and private collectors to effectively manage their collections, exhibitions and public art projects based on a deep understanding of contemporary artistic processes, materials and museum-standard best practices. Anne Marie is passionate about the enrichment of art in the public sphere, and is experienced with the distinct needs of public/civic art collections. She has held management positions at the San Francisco Arts Commission, the Yerba Buena Center for the Arts and the Museum of Contemporary Art San Diego. She also worked in museum registration at the Art Institute of Chicago and the Los Angeles County Museum of Art.

Laurie Mitchell, M.D., Commissioner, City of San Diego Commission for Arts and Culture

Laurie Mitchell is a general pediatrician who has practiced in East County community clinics for the past ten years, most recently working at Southern Indian Health Council. She and her husband, Brent Woods, have been active supports of the Museum of Contemporary Art San Diego (MCASD), San Diego Museum of Art, the Old Globe Theatre, and Mingei International Museum. In addition, she currently serves on the Board of Directors of The New Children's Museum, acting as board chair from 2007-2009, and is a member of the Collections Committee of MCASD, as well as the Art Committee of the La Jolla Athenaeum. She has also served on the boards of the San Diego museum of Man and City Ballet of San Diego, where she continues to serve on the Advisory Council. Dr. Mitchell received a B.A. degree in English literature from Wellesley College, and an M.D. from the University of Texas Southwestern Medical School. She completed her pediatrics residency training at the Children's Hospital of Philadelphia.

Art Committee Member TBD

Parking Plaza Lobby Stair Public Art Opportunity

Project Description:

Artists and artist teams are invited to submit qualifications for the Parking Plaza Lobby Stair Public Art Opportunity. The new parking plaza is expected to be a 3 story building of approximately 1,000,000 square feet with 3000 parking spaces. The Parking Plaza is anticipated to be a post-tensioned concrete structure and will be located on the current footprint of the Terminal 2 West parking lot.

The project is an opportunity for an artist or artist team to activate the exterior, terminal-facing sides of the plaza's three lobby stairwells, which serve as pedestrian entry and exit points for the structure. The artwork should feature unique and memorable sculptural elements that create a visual screen in front of the stairwells, while still allowing for visibility, transparency, and ventilation. The sculptural treatment should have a light and airy quality to complement the open design of the lobby. While the three elements should clearly share a common theme or leitmotif, each should possess a distinctive character through differentiation of texture, pattern, material, technique, or effect.

The artist or artist team selected for this opportunity will collaborate closely with the Design Team throughout the design, construction, and installation process.

Estimated Budget: \$550,000

RFQ Release Date: May 2, 2016



Proposed artwork site, Parking Plaza Lobby Stair



“Boulevard” (working title)
San Diego International Airport
Phase 2A

BALL-NOGUES STUDIO

19 April 2016

Narrative

Our intent is for the artwork to unfold during the visitor's passage by foot from their parking spot to the terminal; it is inherently linked to one's journey. The artwork will be distributed through the light well as a series that increases in size as one moves towards the terminal. The piece will be made up of separate hanging forms that each seem to grow downward as an expansion on the previous form. The experience of the artwork will be similar to driving along a palm tree lined boulevard or landing on a runway. Each of the forms will visually come together to make a colonnade that crescendos or tapers, depending on the traveller's direction.

Palm tree lined streets are an iconic symbol of southern California and its car culture. Even for tourists, the rhythm of passing trees along a roadway is familiar from films. Our piece will be about this movement, as well as the overlapping forms seen from some viewpoints and the negative space between the individual "trees" seen in other viewpoints. The branching is inspired by palm fronds, as well as various fractal patterns seen in nature such as coral. The way our trees each appear to shrink while traveling away from the terminal can be compared to the experience of departing in a plane, where the taxiway and landscape shrink into patterns.

Our strategy, while not intended to replace way finding, will provide directional orientation for the traveler in the otherwise undifferentiated field of the parking structure. There are many materials could be employed to create these forms. For example, carbon fiber roving could be woven into a strong lightweight structure. Another material option might be to weld stainless steel rod. Or we could create a series of custom injection molded parts that incorporate several repeating modules. Additionally, we could incorporate variations of color or texture.





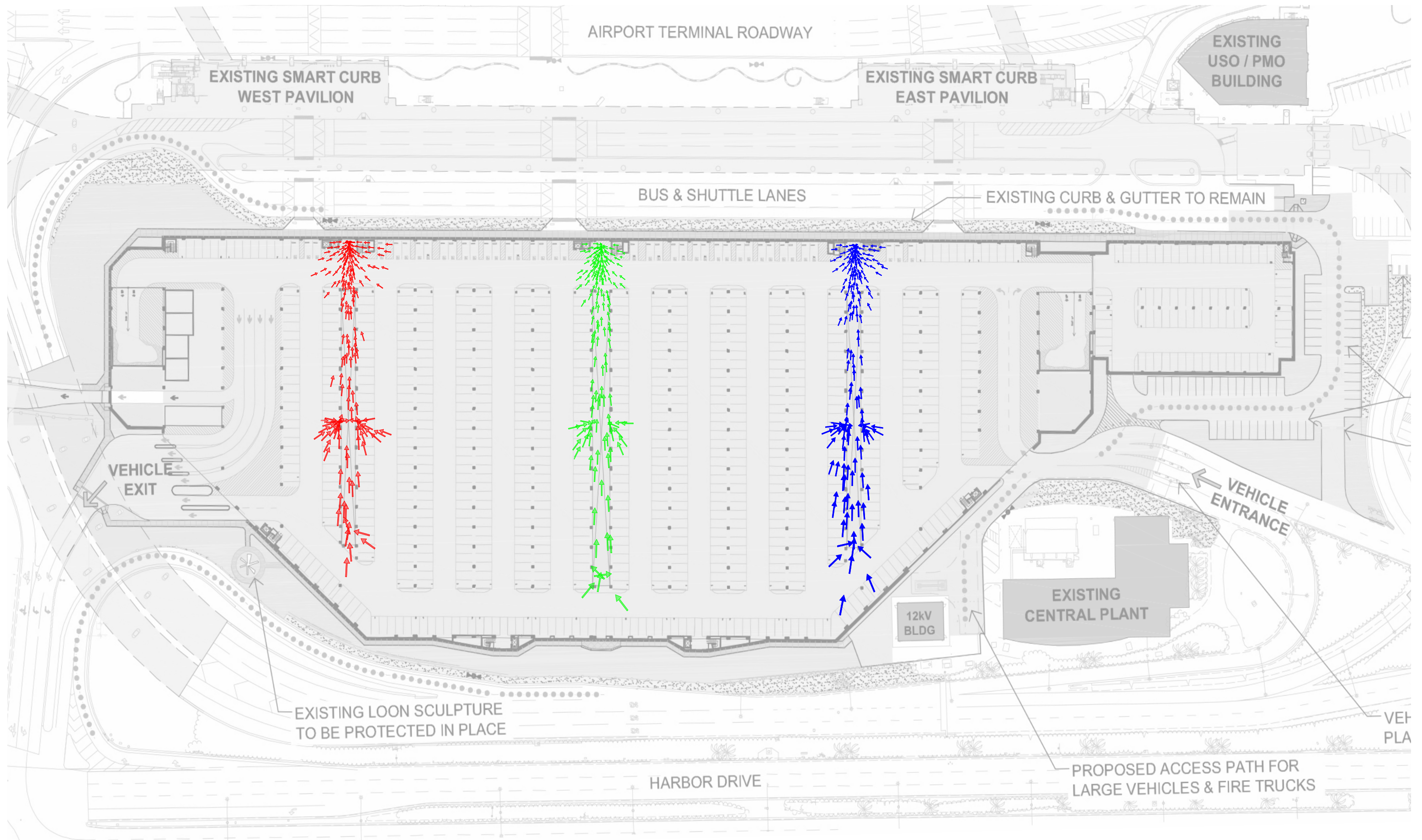

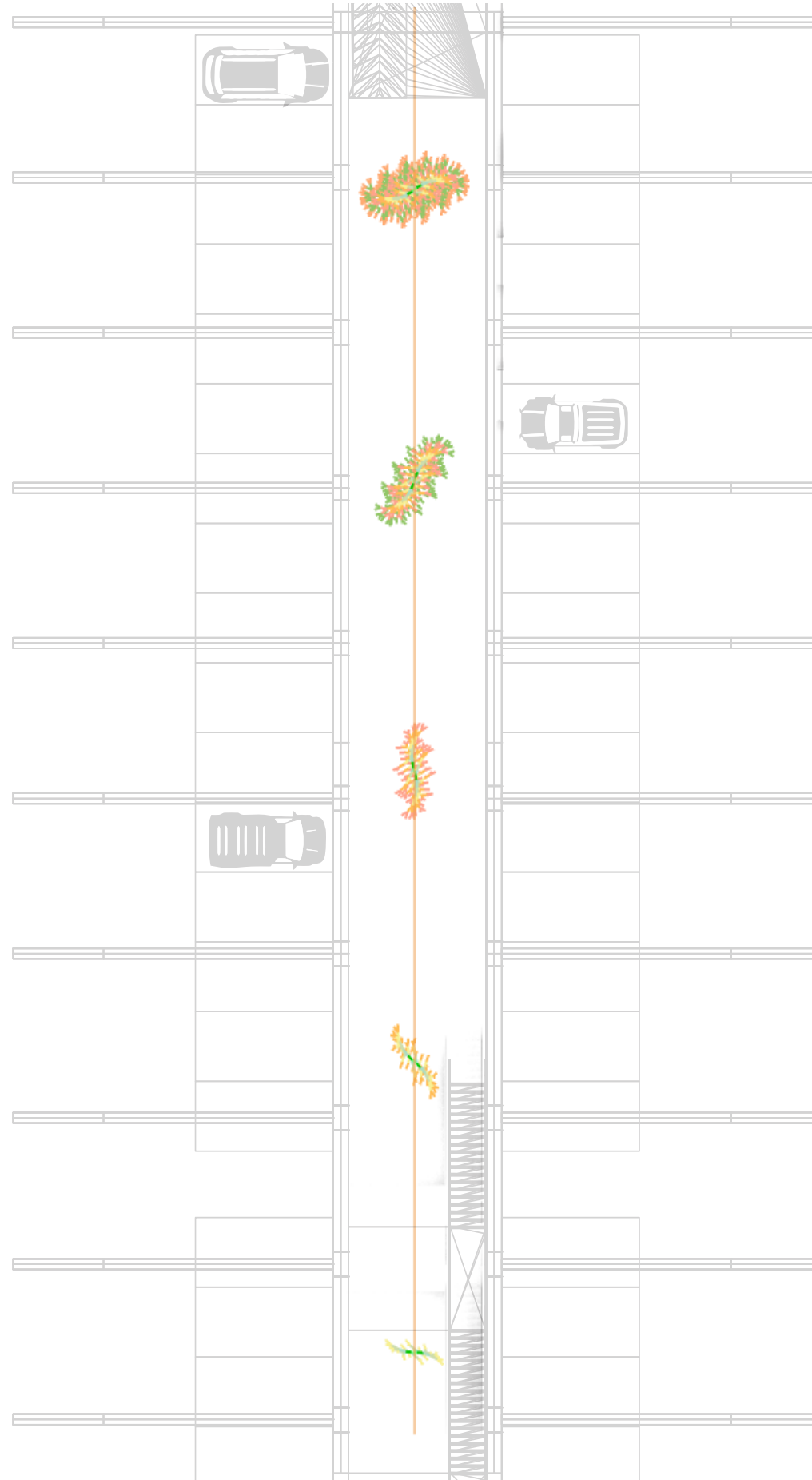

San Diego International Airport - Concept

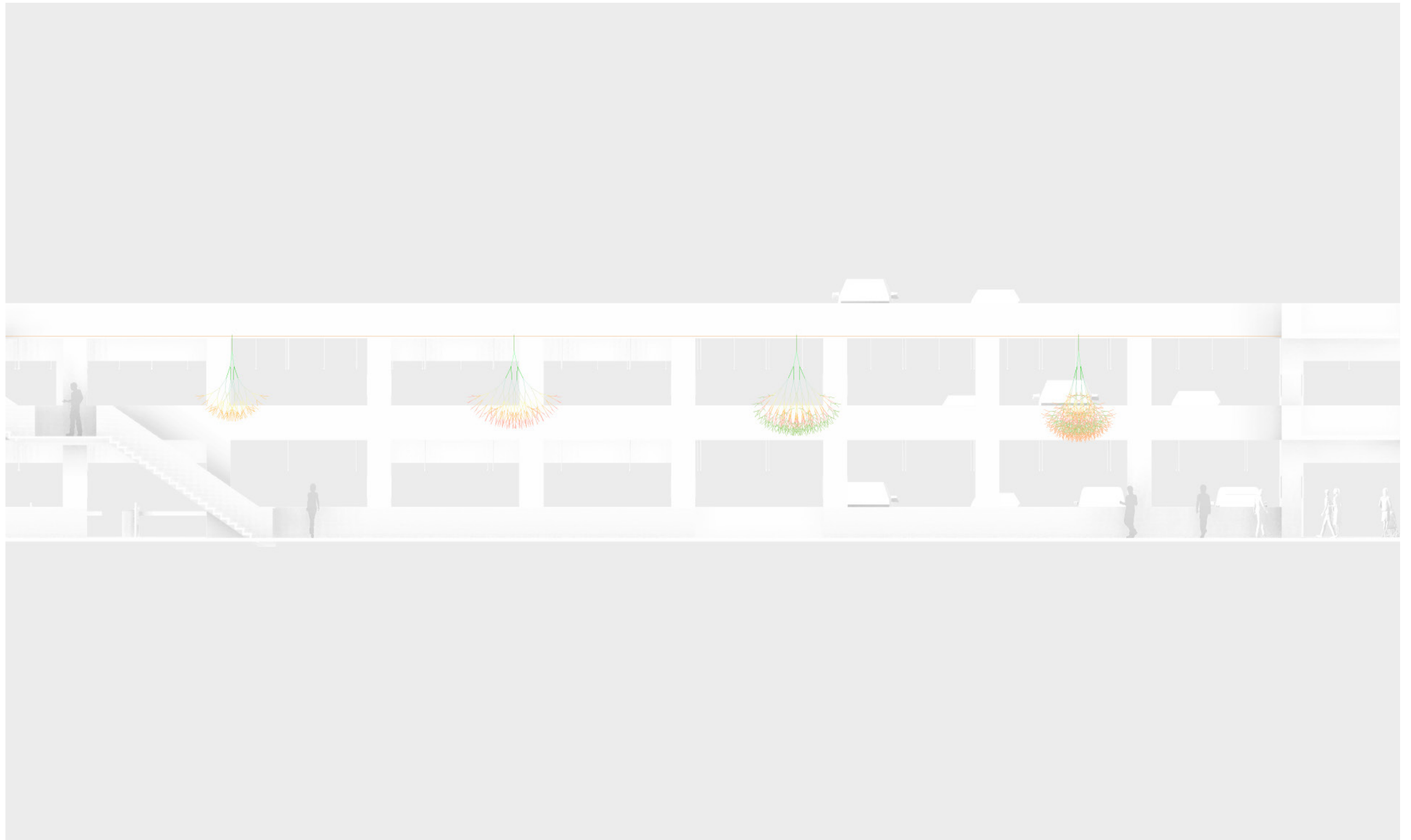

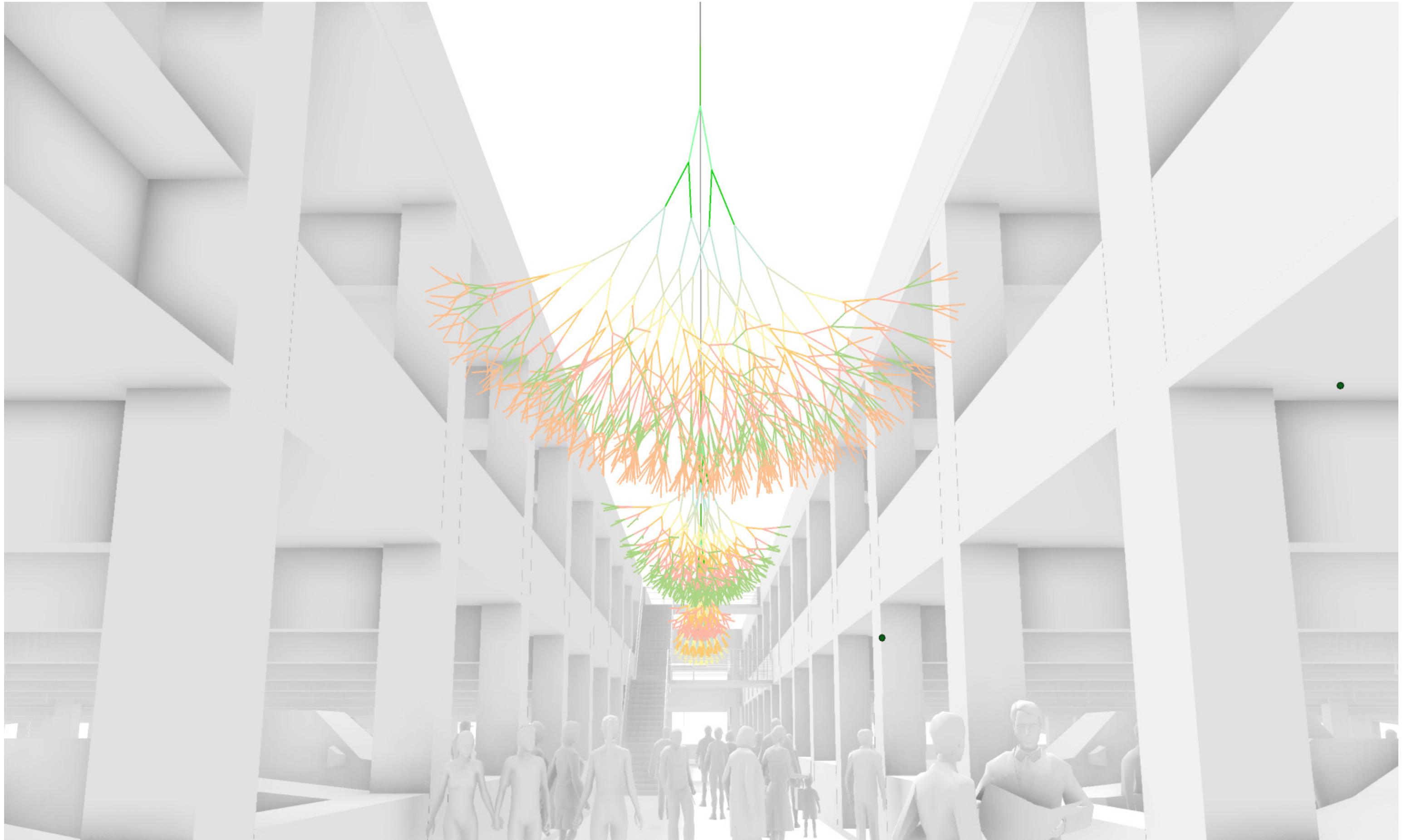

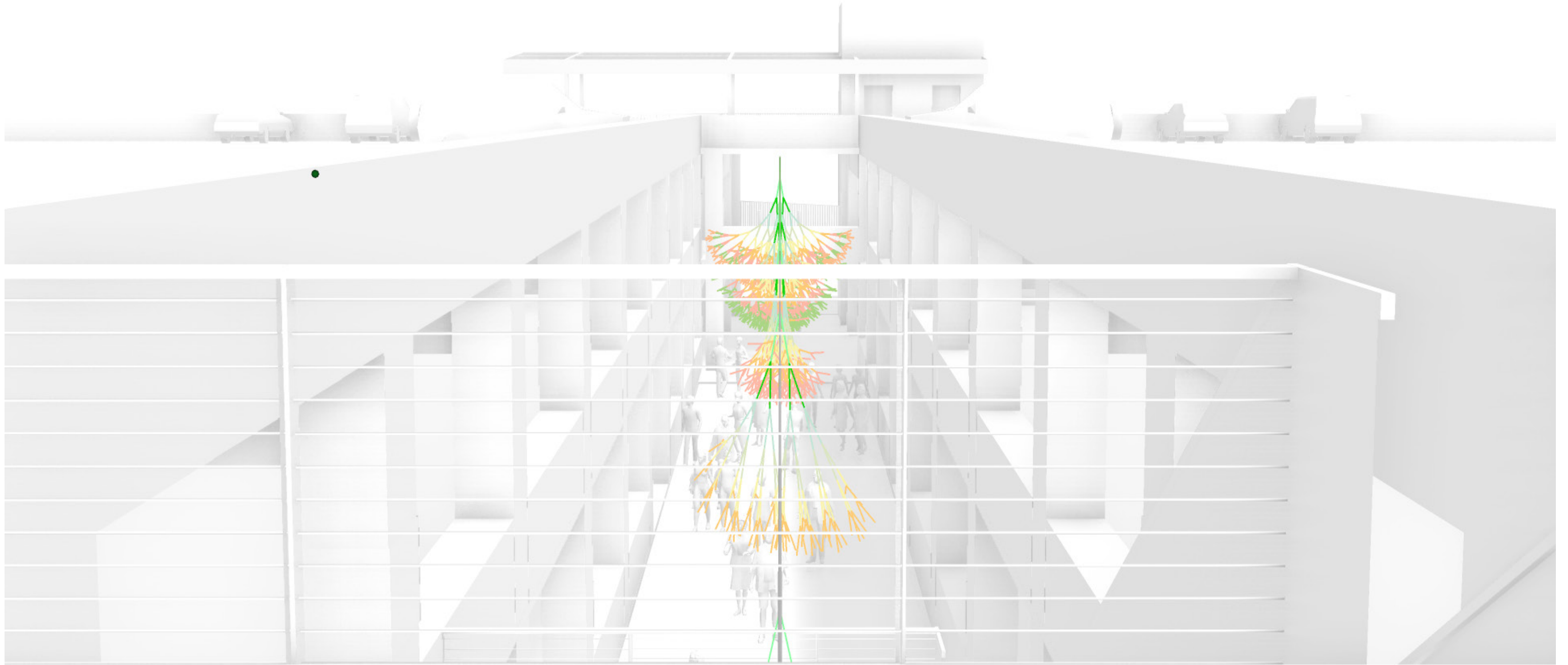

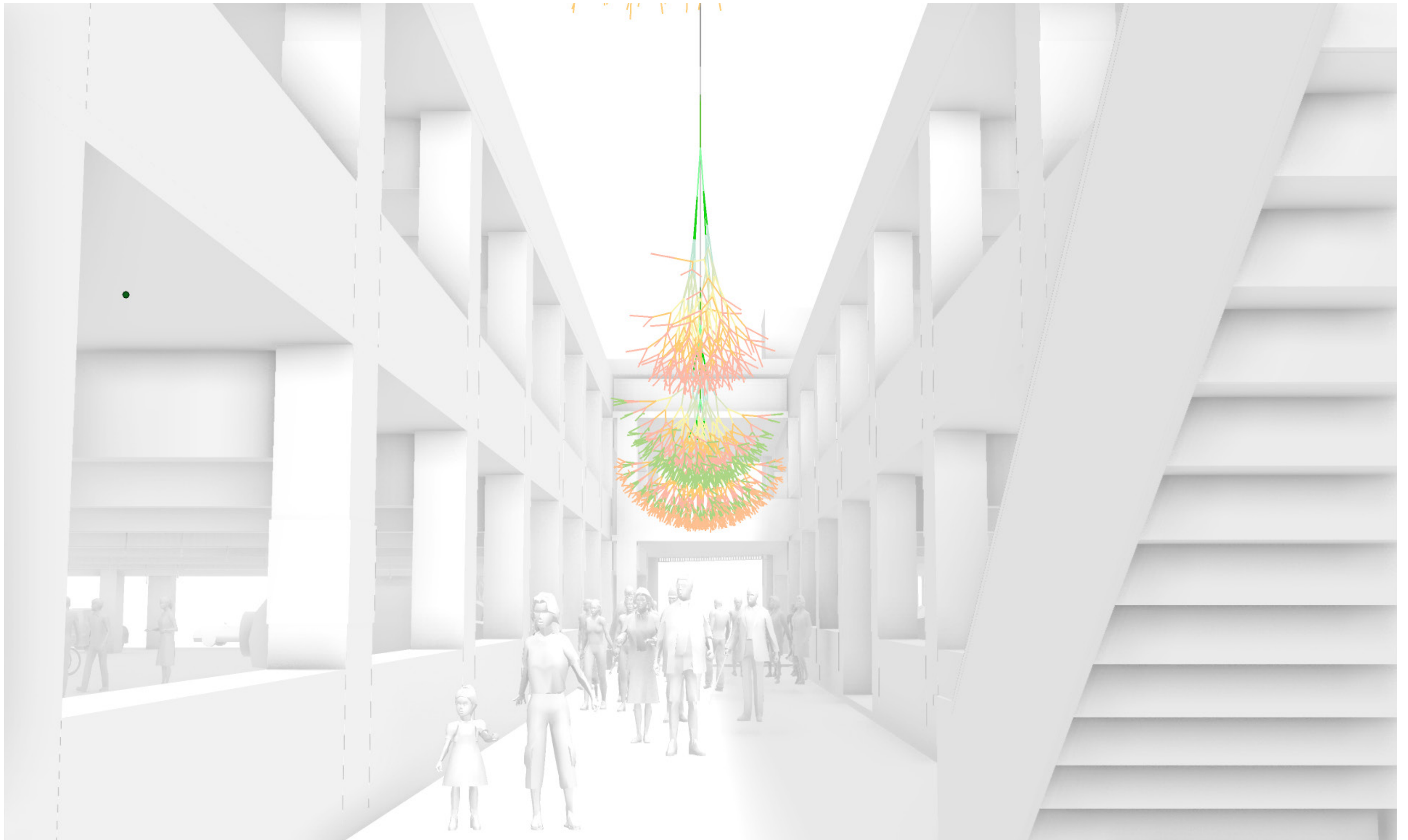

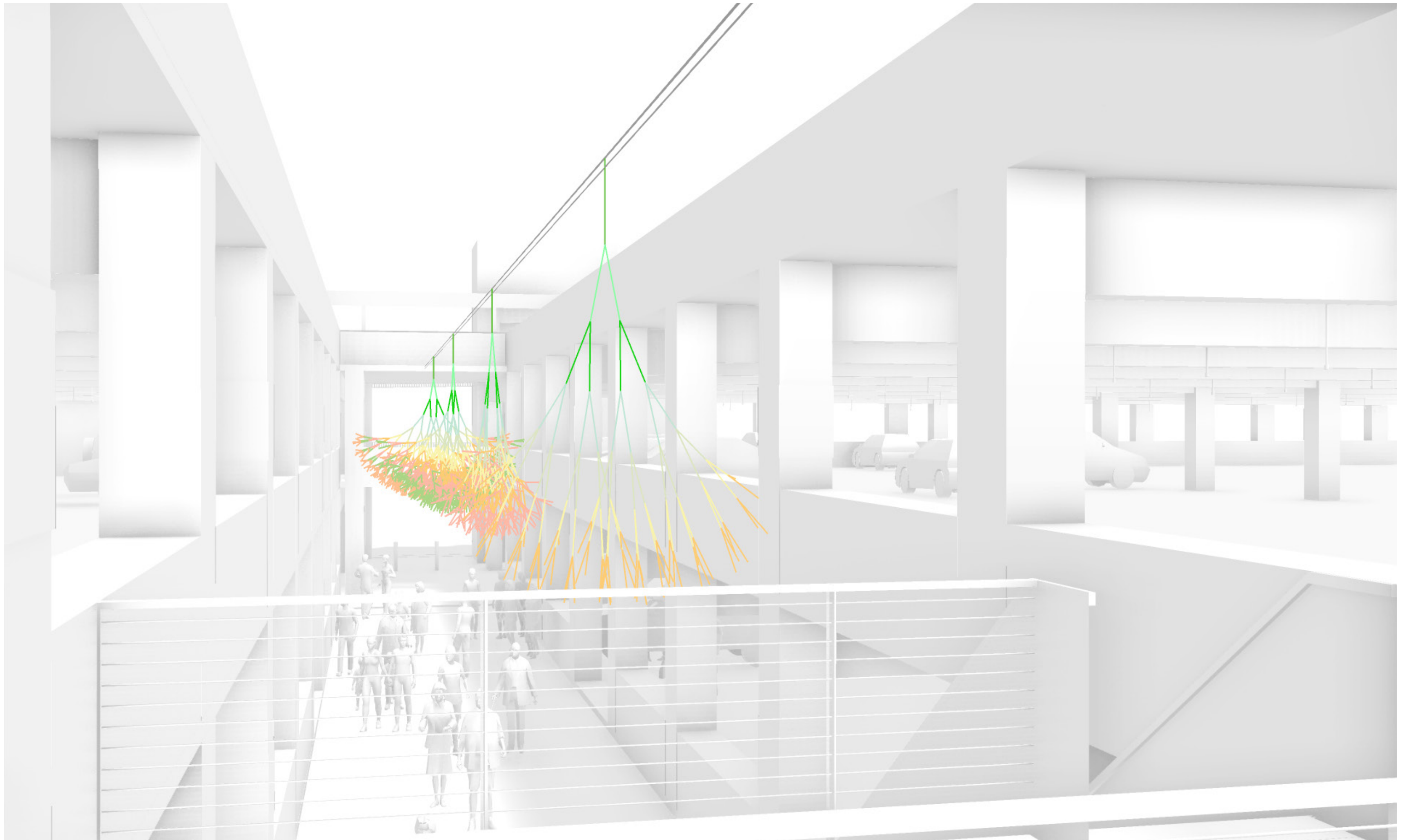

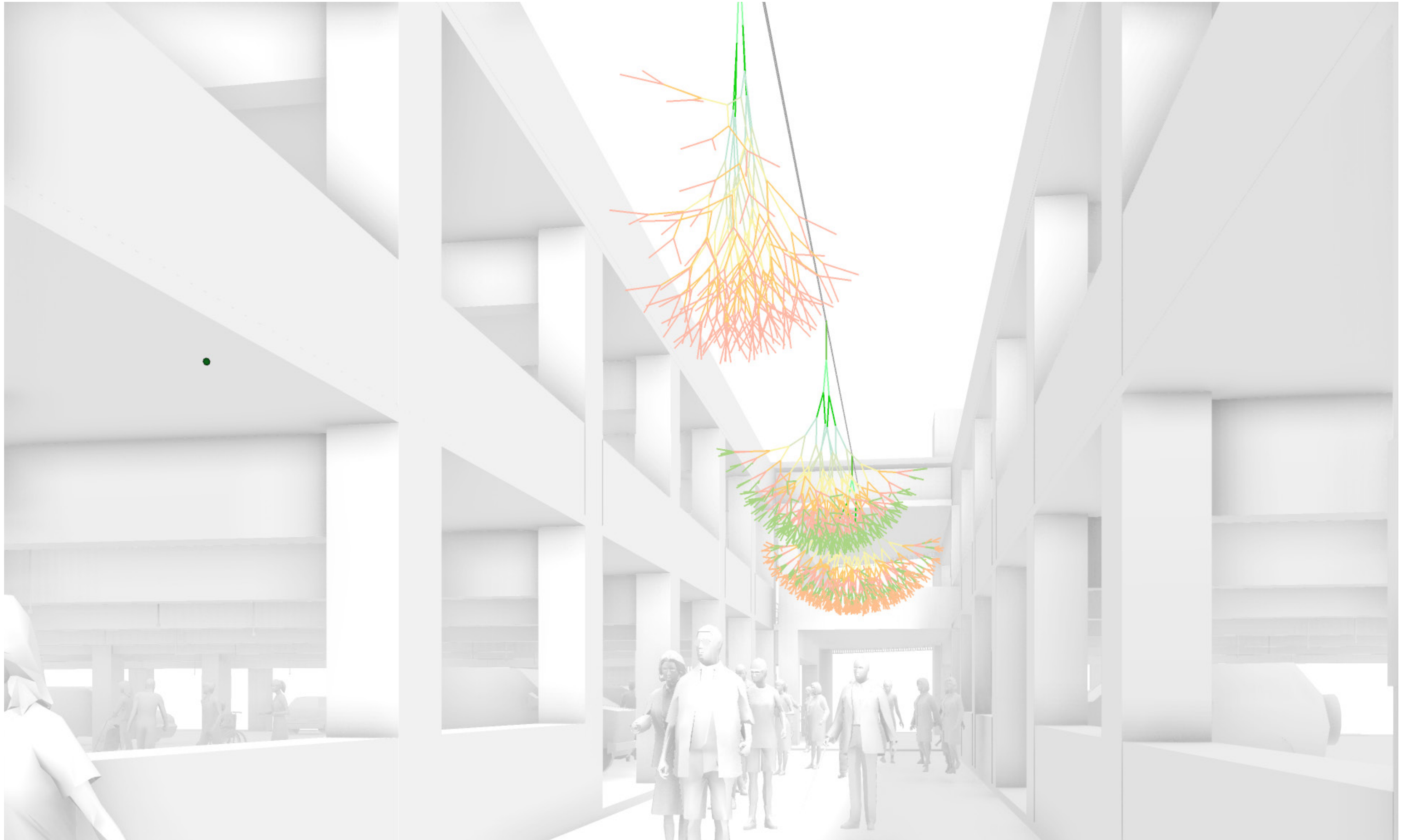

MATERIALS AND PROCESSES



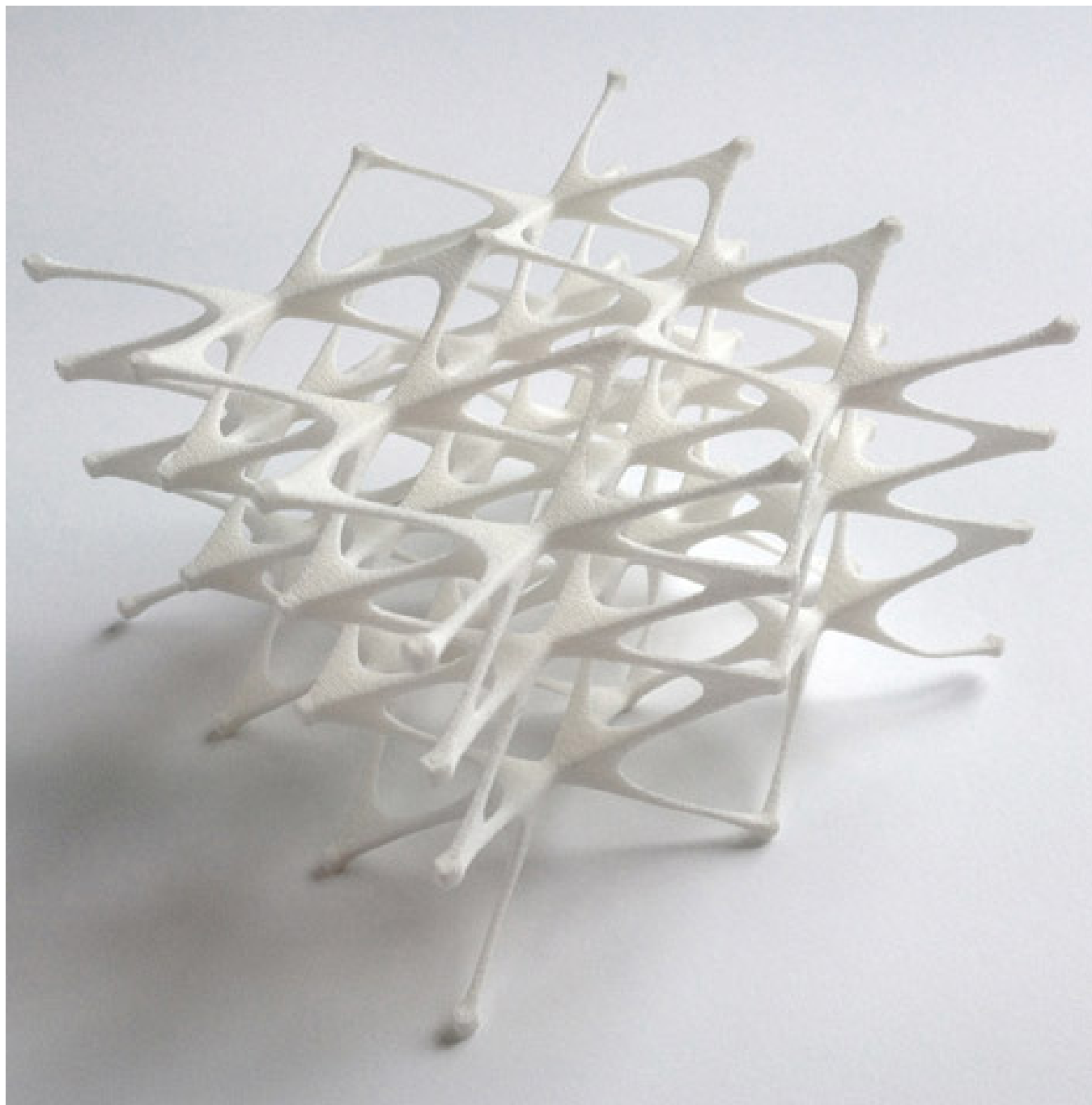

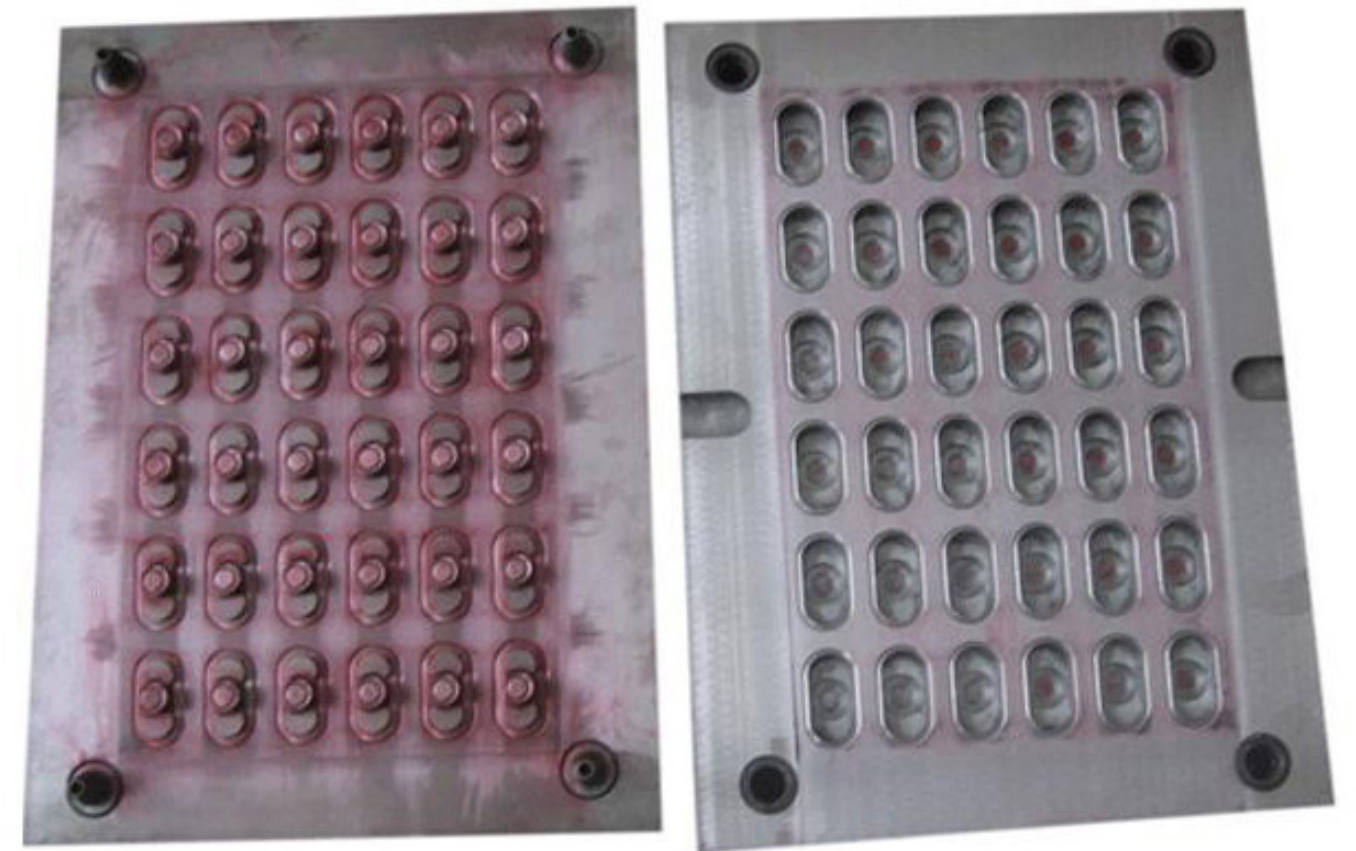



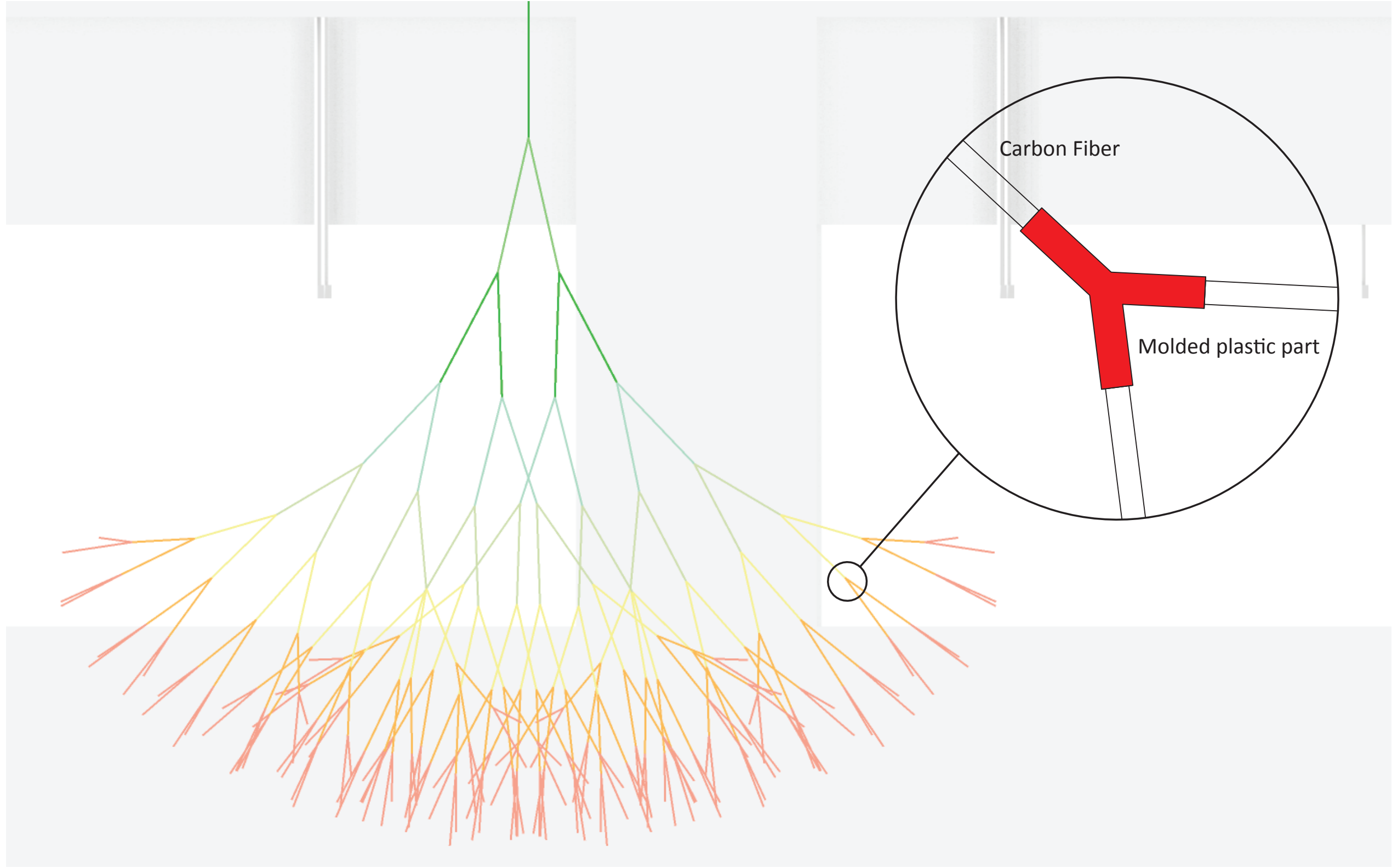



Rhinoliner



Color samples



San Diego Airport Artwork – Preliminary Fabrication & Installation Plan

1. Structural Anchorage Preparation (by building contractor or equivalent)

Approximately 8 weeks

The particulars of this step will be determined after discussions with the architects, contractor, and building engineer. The steps will be conducted in coordination with the building construction schedule. While it is too soon to know the precise steps, we have outlined one possible scenario here.

1. Calculate reactions of artwork at anchorage points
2. Provide reactions to facility structural engineer
3. Submit permit set for structural anchorage to San Diego Department of Buildings and Safety
4. Shop drawings of anchorage points and receiving brackets
5. Coordinate installation sequence with General Contractor/Facilities team and client
6. Ball-Nogues approval of anchorage points and receiving brackets
7. City and facility approval of anchorage points and receiving brackets, if necessary

2. Fabrication and Assembly (by Ball-Nogues Studio)

Approximately 19 weeks

The project will be constructed primarily using custom configured chain and cable materials with custom coating applications.

1. Generate custom programming and content
2. Cut primary components to length
3. Splice cables and guy wire according to programmed sequence
4. Organize all strands for sequential assembly
5. Label and package all parts for installation
6. Crate all parts for shipping, as necessary
7. Ship to site

3. Installation (By Ball-Nogues Studio)

Approximately 3 weeks

Installation will be fabricated at Ball-Nogues Studio in Los Angeles and shipped in crates to San Diego, California, then preassembled and installed by Ball-Nogues with the help, if necessary, of a local contractor. In San Diego, it will be attached to an anchorage system that will be seamlessly integrated into the building prior to the commencement of install. The precise method of hoisting will be determined according to a professional rigging contractor's recommendations and in conjunction with the building logistics schedule.

1. Staging
2. Layout pieces in order and appropriate position
3. Sequentially install artwork and secure to structure for tensioning
4. Ball-Nogues, Client and City approval
5. Clean up

San Diego Airport Artwork – Preliminary Materials & Suppliers List

Materials

Materials for scheme may include:

1. 24K Carbon Fiber Tow
2. Stainless Steel connection cable
3. Resin
4. 3100K White LED Ellipsoidal

Potential Suppliers

Fibre Glast Developments Corp

385 Carr Drive
Brookville, OH 45309
Phone 800-838-8984
Fax 937-833-6555
www.fibreglast.com

Jakob Rope Systems

Dorfstrasse 34
CH-3555 Trubschachen
Switzerland
Phone +41 (0)34-495-1010
www.jakob.com

Stage Lighting Store

4827 Philips Hwy
Suite 2
Jacksonville, FL 32207
Phone 904-683-5553
www.stagelightingstore.com

McMaster-Carr Supply Co

9630 Norwalk Blvd.
Santa Fe Springs, CA 90670
Phone 562-692-5911
www.mcmaster.com

San Diego Airport Artwork – Preliminary Maintenance and Safety Plan

Routine Maintenance

In the event that the installation acquire dirt or dust, we recommend using pressurized sprayer to clean when necessary.



It is also recommended that the artwork is cleaned with a pressure washer at least twice per year (see pictures below). Mild soap can be used and then followed by a water rinse, then allowed to air dry.



In the event of cable or plastic components breaking, contact the Artists.

Long Term Maintenance

Stainless Steel and plastic provides several decades of corrosion protection in many environments. Stainless Steel is naturally resistant to oxidation, and plastic can withstand most environments. The cables should therefore require no long-term maintenance due to corrosion and weathering.

Safety

In the event of physical interaction, cables and chains with high tensile strengths will be selected to prevent any breakages of the strands which may result in injuries to the public.

San Diego Airport Artwork – Preliminary Timeline

Phase 1: Design Development

Approximately 10 weeks

- Establish Stakeholder Requirements
- Site/Data Collection and Research
- Establish Impact Facilities
- Establish Inter-Team Workflow and Deliverables
- Design Development and Documents
- Stakeholder Design Presentation and Meetings
- Schematic Structural Engineering
- Finalize Design
- Maintenance and Conservation Requirements and Procedures
- Final Design Approvals

Phase 2: Construction Documents

Approximately 20 weeks

- Order Cable, Carbon Fiber, and Resin
- 50% Construction Documents / Present to Stakeholders
- Structural Engineering Construction Drawings
- 100% Construction Documents / Present to Stakeholders
- Plan Check (if required)
- Permitting and Licensing (if required)
- Process Reports
- Construction Document Revision
- Submit to Stakeholders
- Prepare Bid Set
- Bidding Assistance and Bid Evaluation

Phase 3: Fabrication and Installation

Approximately 30 weeks

- Fabricator Meetings / Coordination / Quality Control
- Programming Coordination
- Material Deliverables
- Finish Samples / Sample Parts
- Deliver Work
- Stakeholder Acceptance / Notice to Proceed
- Installation Schedule Review
- Site Preparation
- Revisions and Change Orders
- Evaluate Change and Cost Proposal
- Staging
- On Site Installation
- Progress Reports
- Record Set
- Notification of Completion
- Stakeholder / City Inspection
- Outline Maintenance Guidelines
- Final Acceptance



“Boulevard” (working title)
San Diego International Airport
Phase 2A

BALL-NOGUES STUDIO

19 April 2016

Narrative

Our intent is for the artwork to unfold during the visitor's passage by foot from their parking spot to the terminal; it is inherently linked to one's journey. The artwork will be distributed through the light well as a series that increases in size as one moves towards the terminal. The piece will be made up of separate hanging forms that each seem to grow downward as an expansion on the previous form. The experience of the artwork will be similar to driving along a palm tree lined boulevard or landing on a runway. Each of the forms will visually come together to make a colonnade that crescendos or tapers, depending on the traveller's direction.

Palm tree lined streets are an iconic symbol of southern California and its car culture. Even for tourists, the rhythm of passing trees along a roadway is familiar from films. Our piece will be about this movement, as well as the overlapping forms seen from some viewpoints and the negative space between the individual "trees" seen in other viewpoints. The branching is inspired by palm fronds, as well as various fractal patterns seen in nature such as coral. The way our trees each appear to shrink while traveling away from the terminal can be compared to the experience of departing in a plane, where the taxiway and landscape shrink into patterns.

Our strategy, while not intended to replace way finding, will provide directional orientation for the traveler in the otherwise undifferentiated field of the parking structure. There are many materials could be employed to create these forms. For example, carbon fiber roving could be woven into a strong lightweight structure. Another material option might be to weld stainless steel rod. Or we could create a series of custom injection molded parts that incorporate several repeating modules. Additionally, we could incorporate variations of color or texture.





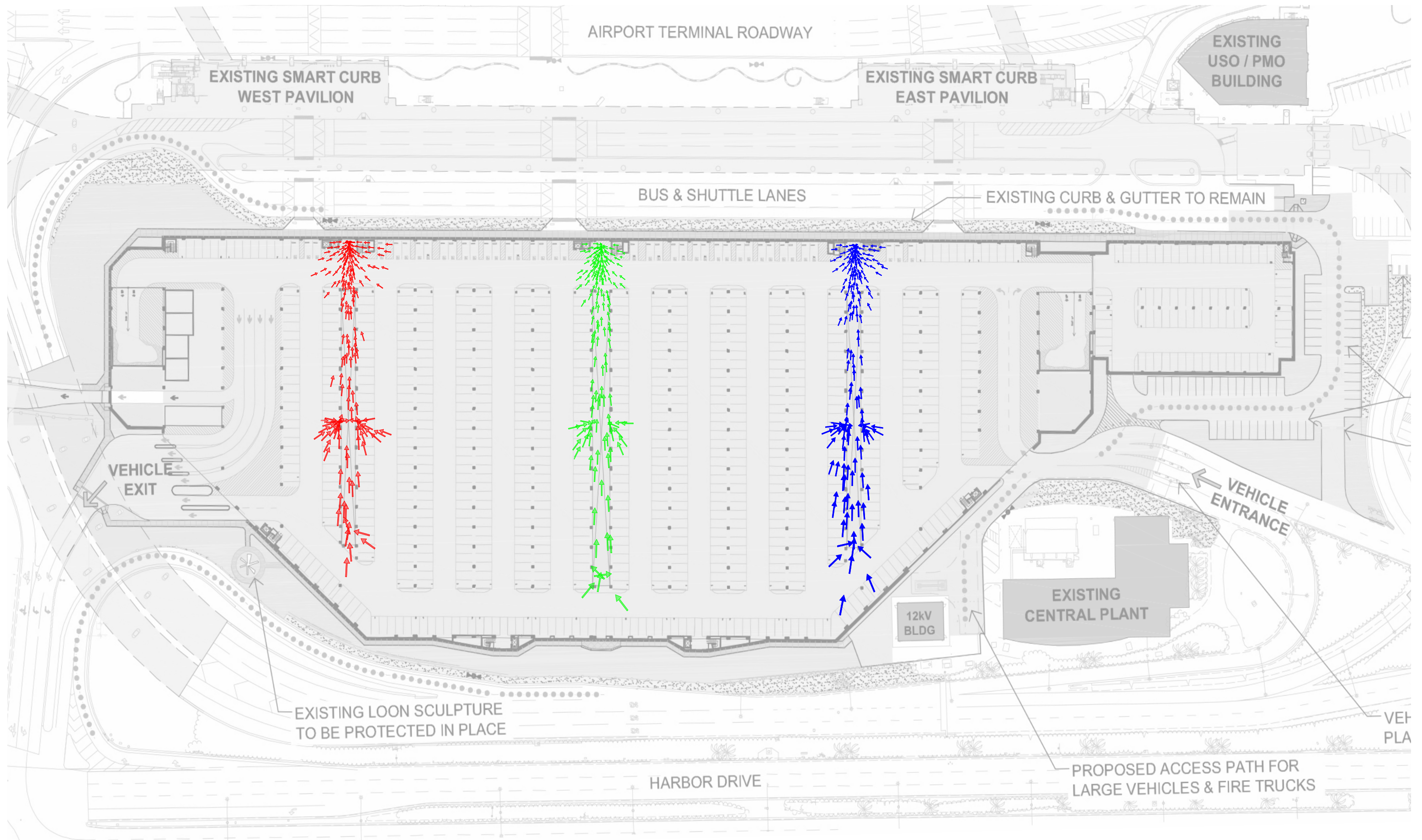

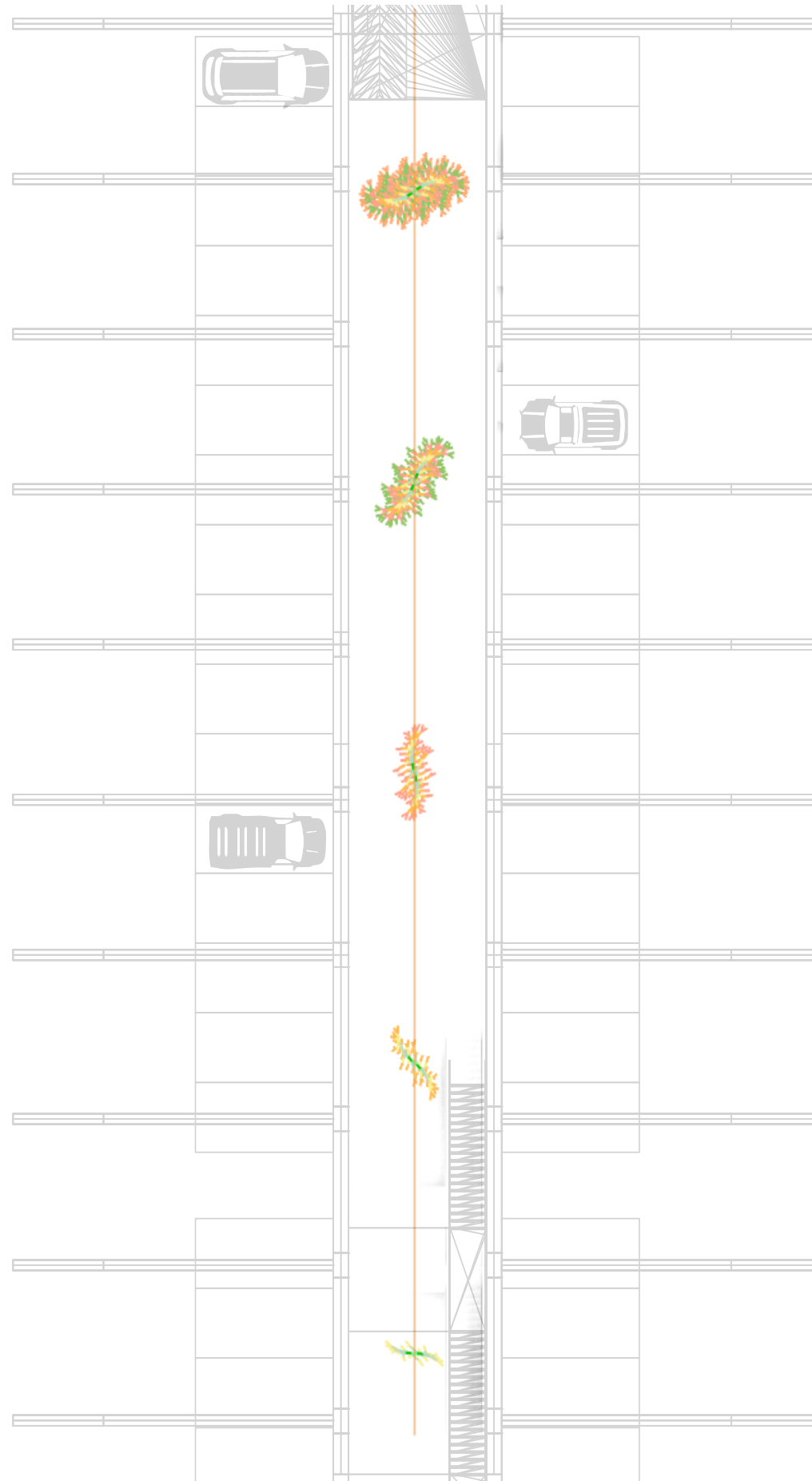

San Diego International Airport - Concept



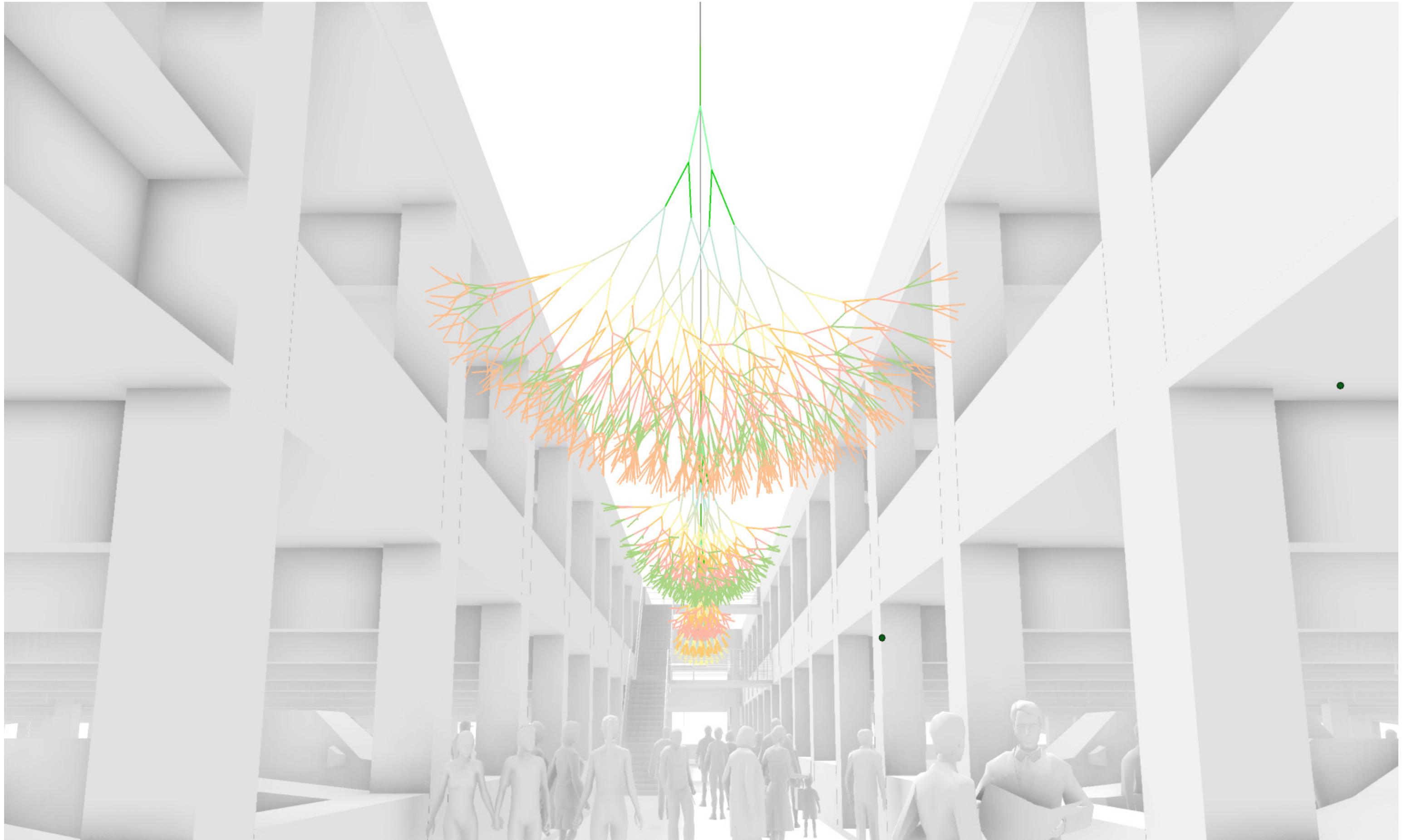

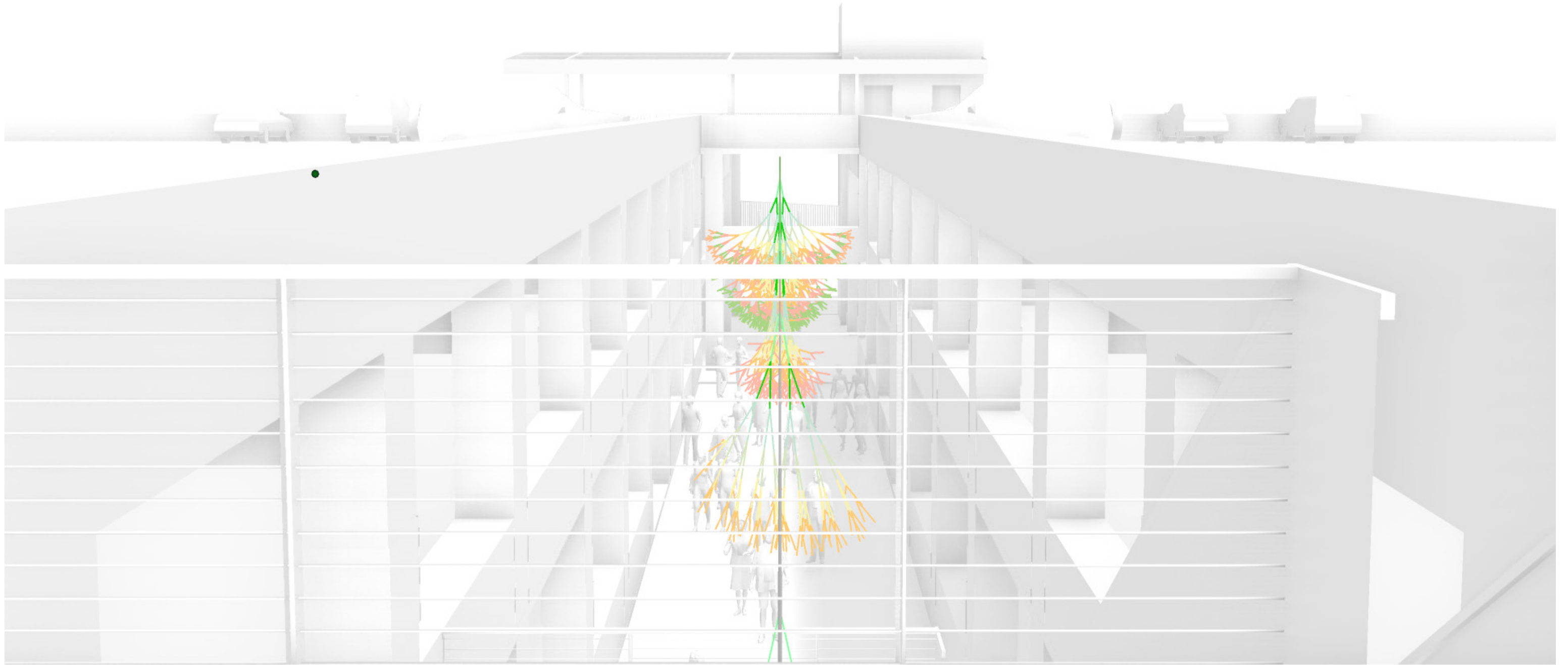

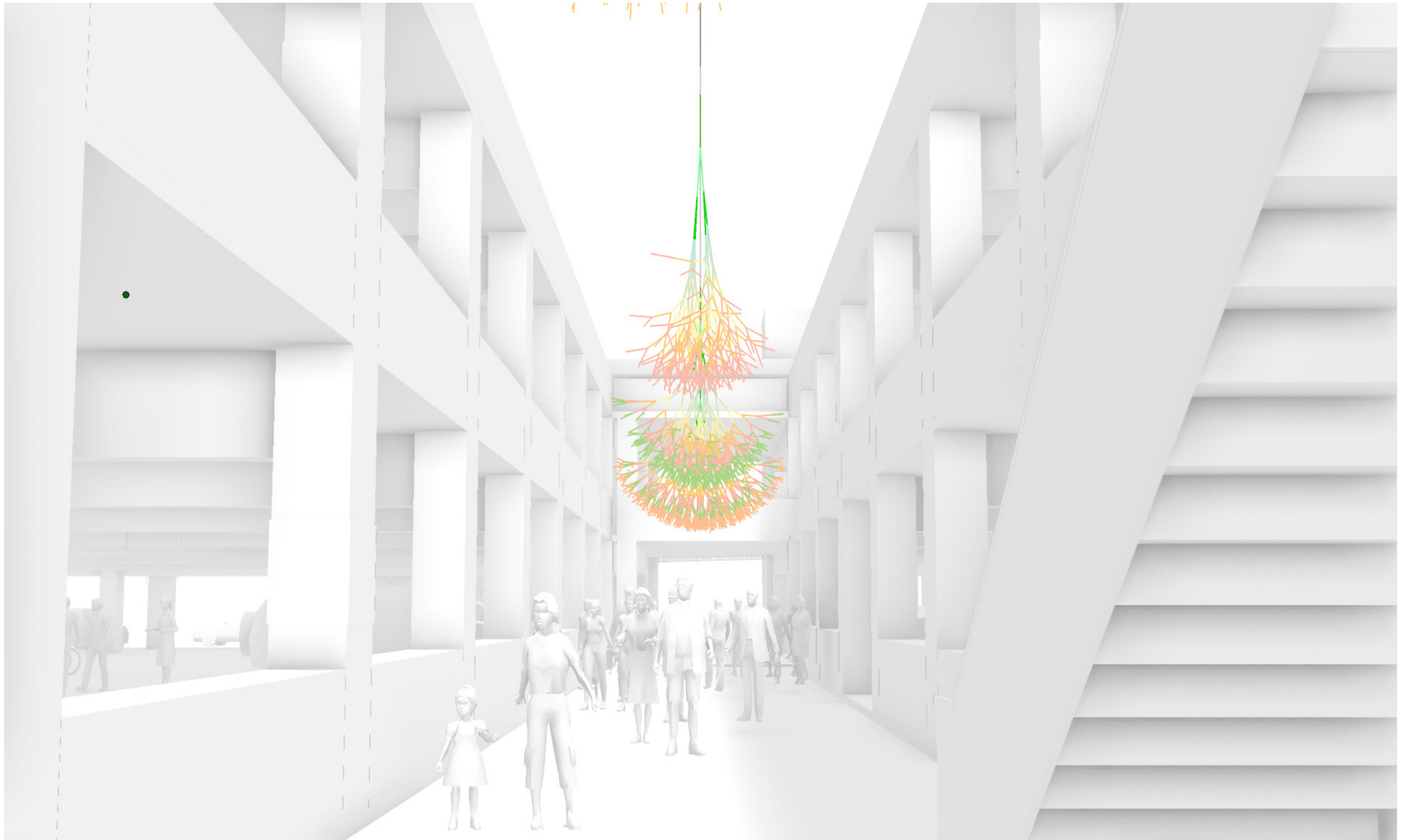

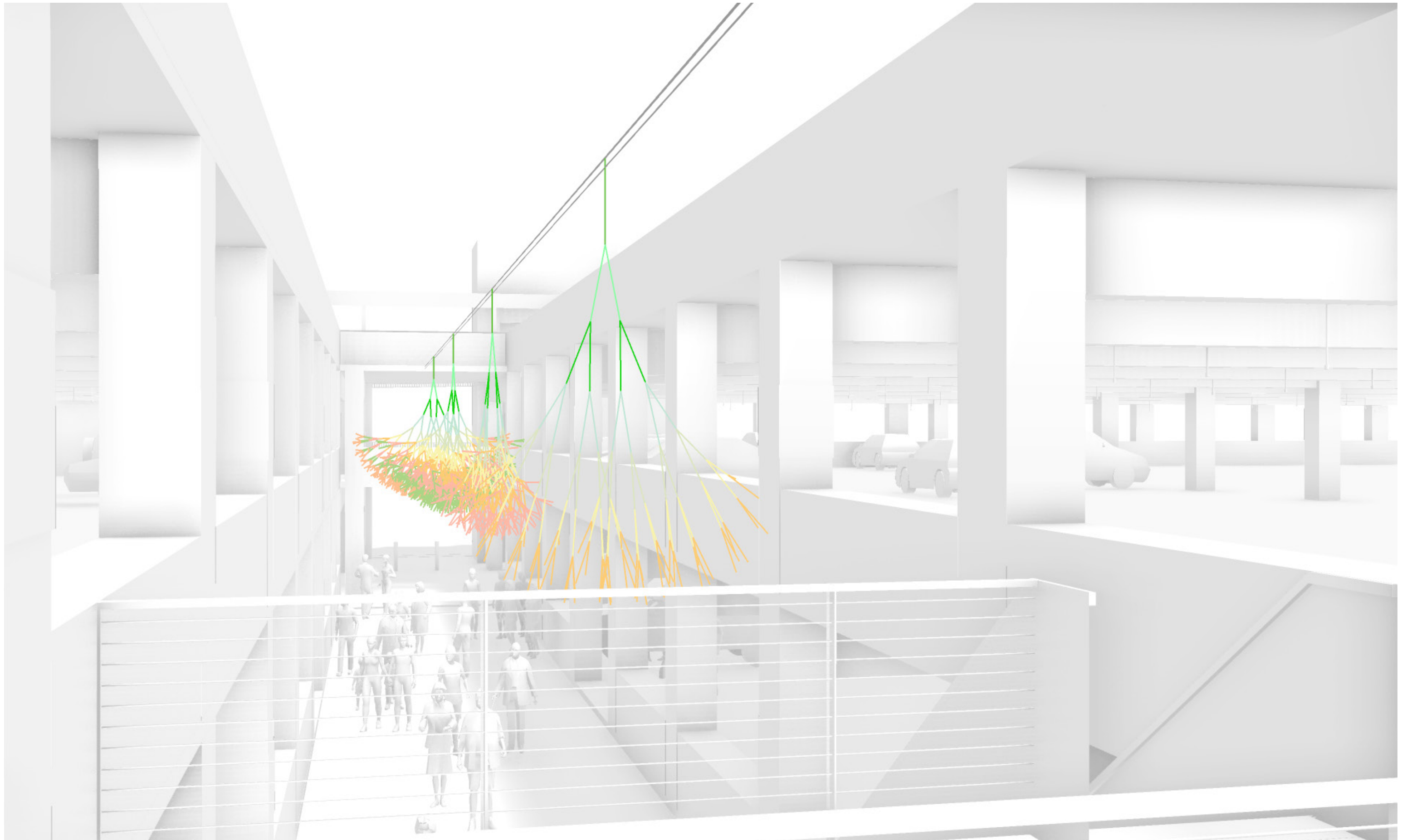

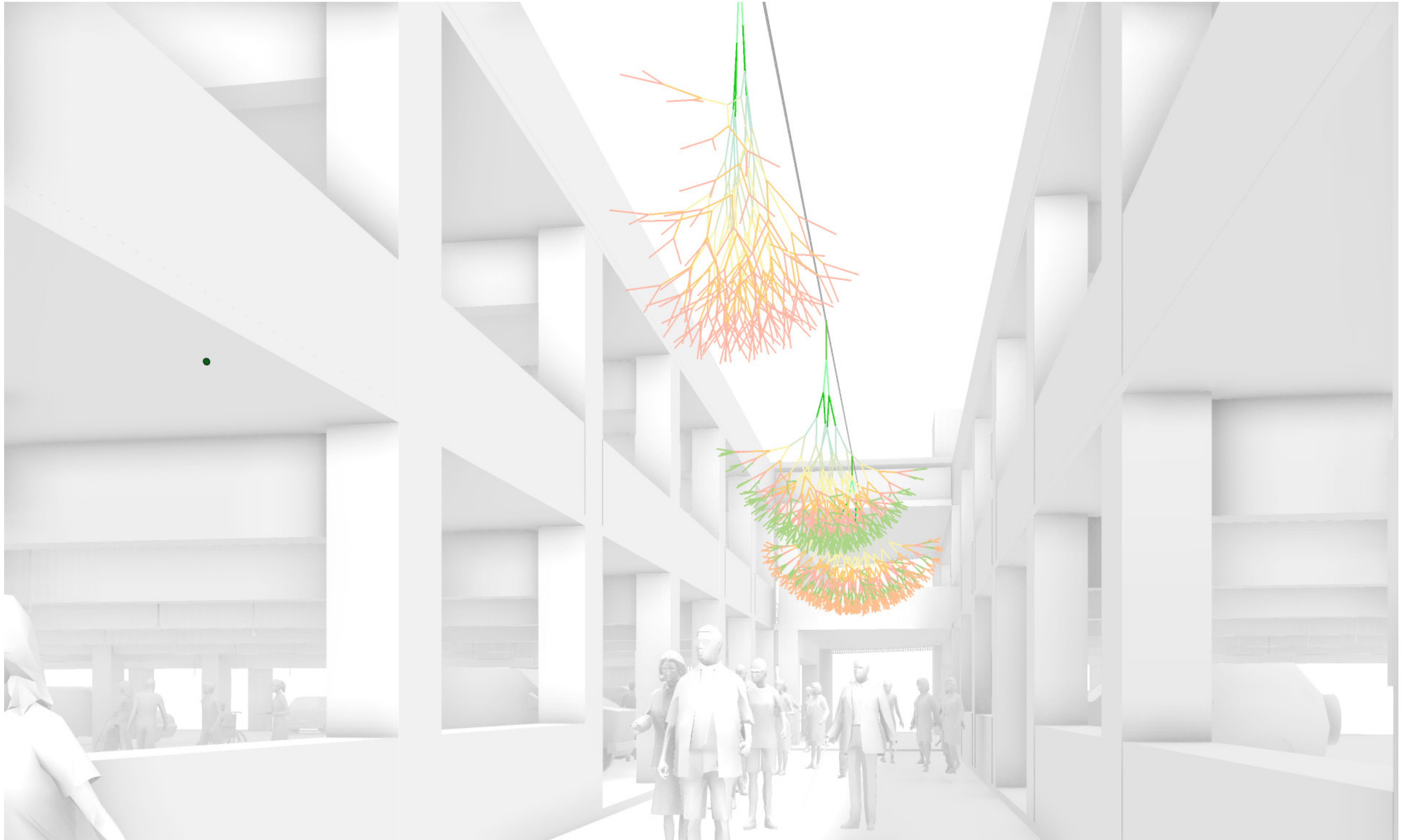

MATERIALS AND PROCESSES

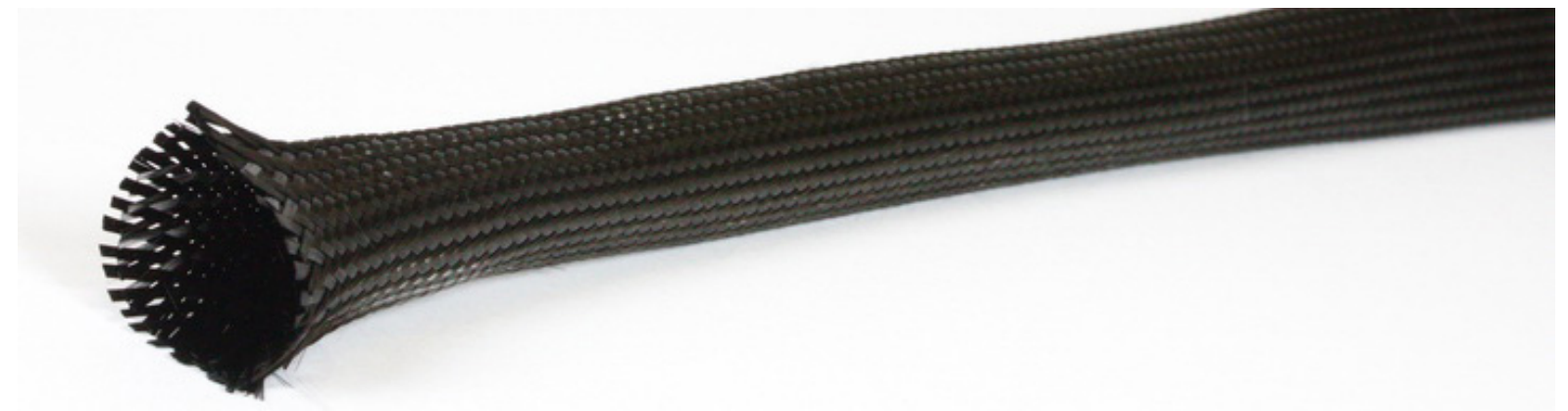

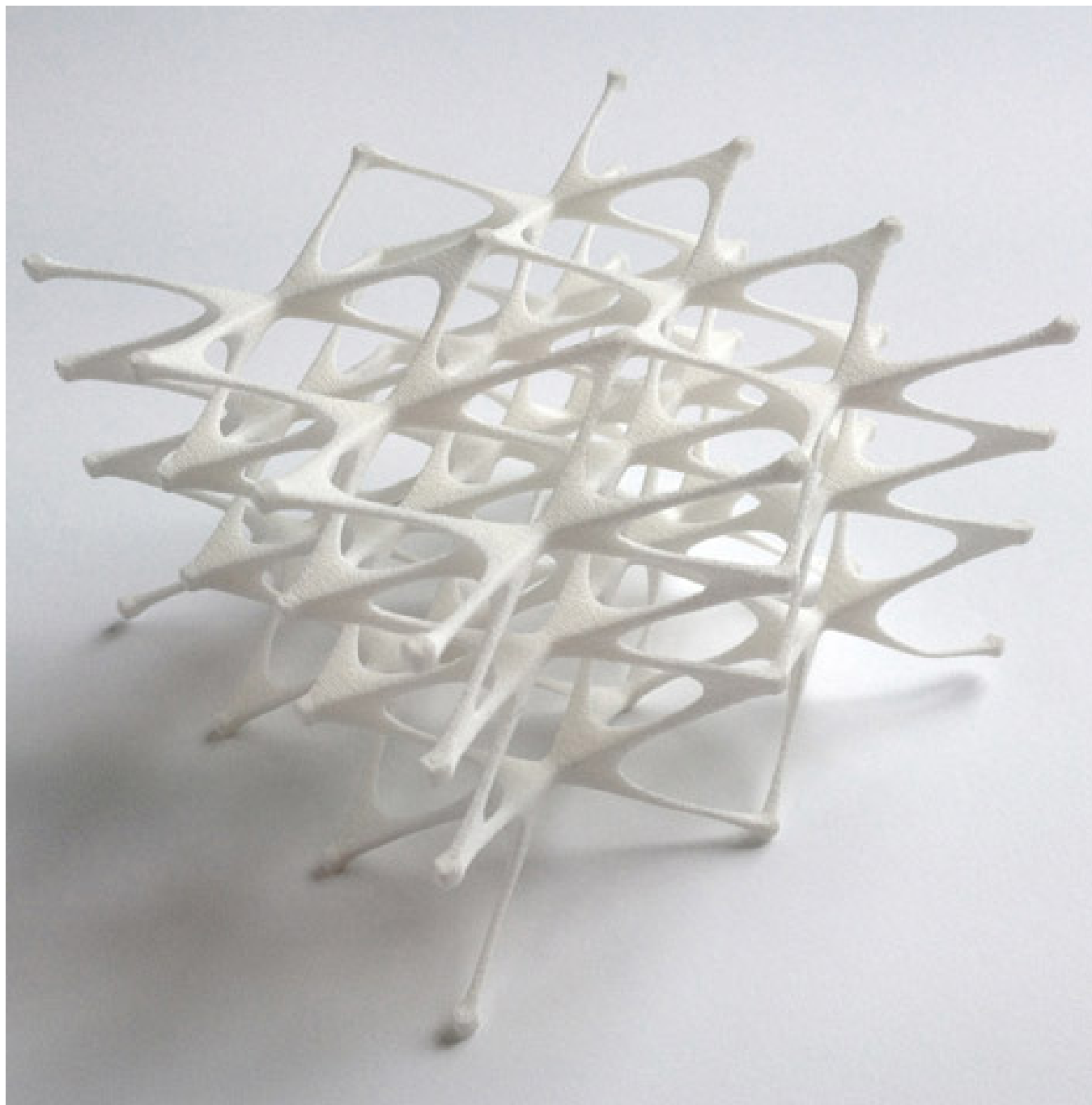

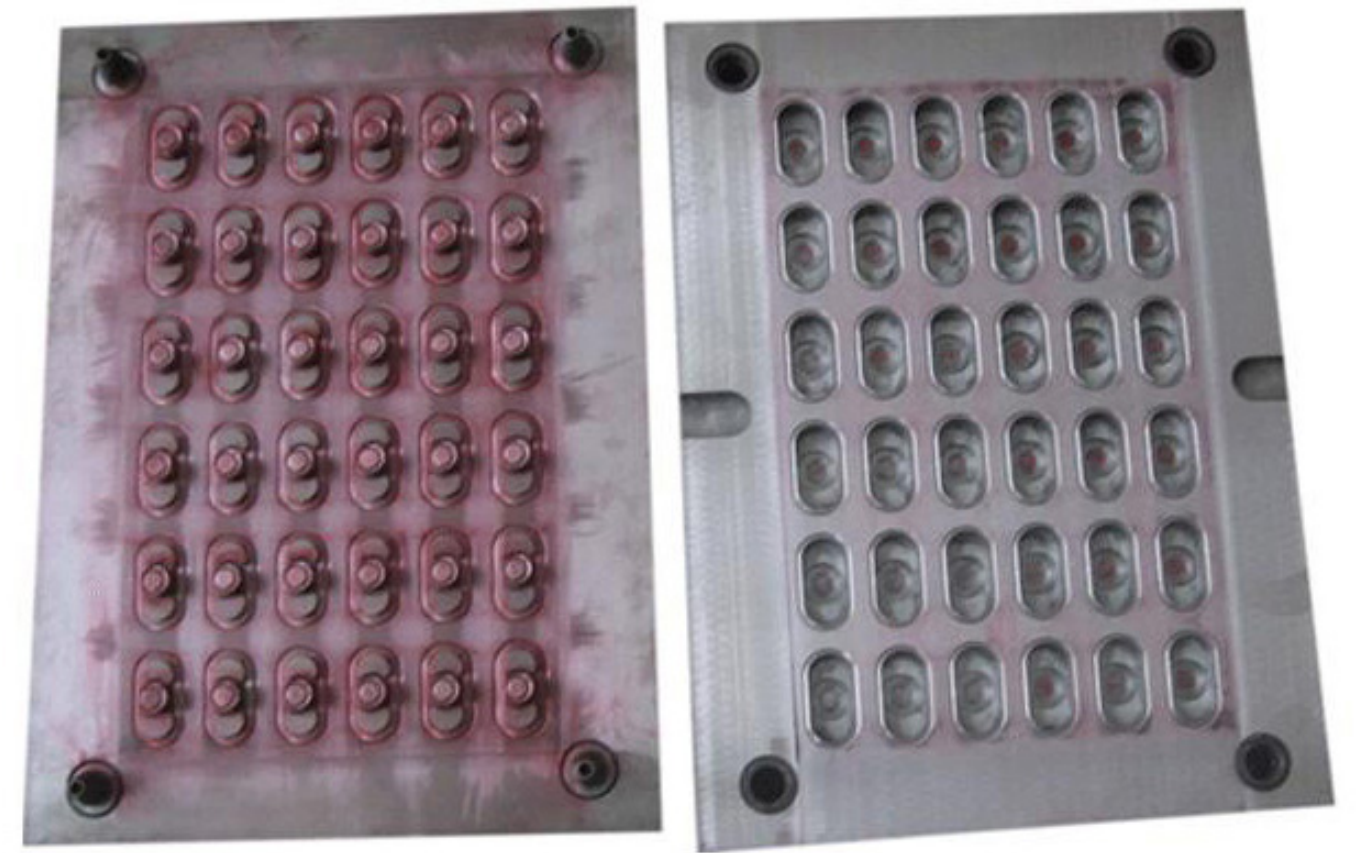



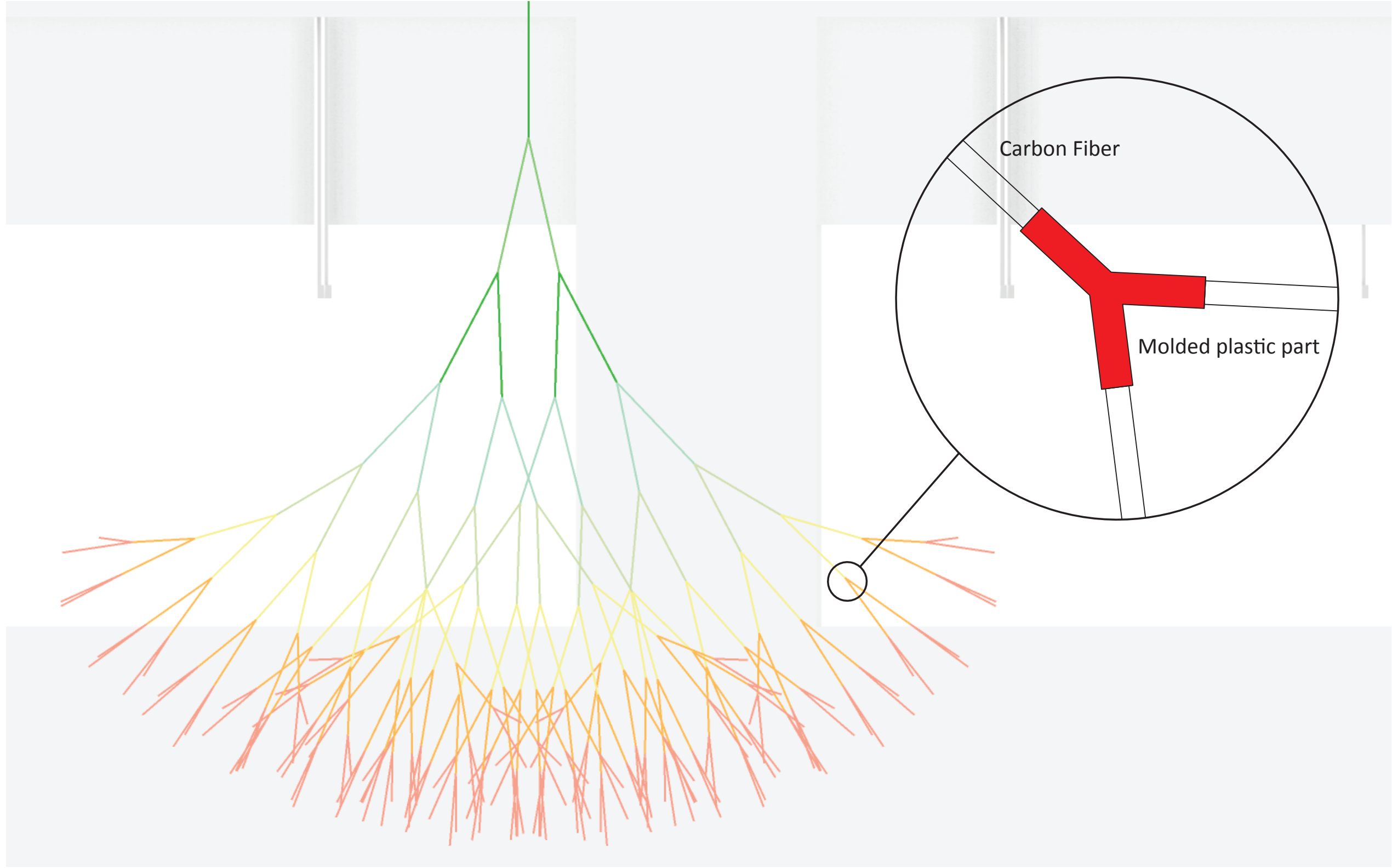



Rhinoliner



Color samples



San Diego Airport Artwork – Preliminary Fabrication & Installation Plan

1. Structural Anchorage Preparation (by building contractor or equivalent)

Approximately 8 weeks

The particulars of this step will be determined after discussions with the architects, contractor, and building engineer. The steps will be conducted in coordination with the building construction schedule. While it is too soon to know the precise steps, we have outlined one possible scenario here.

1. Calculate reactions of artwork at anchorage points
2. Provide reactions to facility structural engineer
3. Submit permit set for structural anchorage to San Diego Department of Buildings and Safety
4. Shop drawings of anchorage points and receiving brackets
5. Coordinate installation sequence with General Contractor/Facilities team and client
6. Ball-Nogues approval of anchorage points and receiving brackets
7. City and facility approval of anchorage points and receiving brackets, if necessary

2. Fabrication and Assembly (by Ball-Nogues Studio)

Approximately 19 weeks

The project will be constructed primarily using custom configured chain and cable materials with custom coating applications.

1. Generate custom programming and content
2. Cut primary components to length
3. Splice cables and guy wire according to programmed sequence
4. Organize all strands for sequential assembly
5. Label and package all parts for installation
6. Crate all parts for shipping, as necessary
7. Ship to site

3. Installation (By Ball-Nogues Studio)

Approximately 3 weeks

Installation will be fabricated at Ball-Nogues Studio in Los Angeles and shipped in crates to San Diego, California, then preassembled and installed by Ball-Nogues with the help, if necessary, of a local contractor. In San Diego, it will be attached to an anchorage system that will be seamlessly integrated into the building prior to the commencement of install. The precise method of hoisting will be determined according to a professional rigging contractor's recommendations and in conjunction with the building logistics schedule.

1. Staging
2. Layout pieces in order and appropriate position
3. Sequentially install artwork and secure to structure for tensioning
4. Ball-Nogues, Client and City approval
5. Clean up

San Diego Airport Artwork – Preliminary Materials & Suppliers List

Materials

Materials for scheme may include:

1. 24K Carbon Fiber Tow
2. Stainless Steel connection cable
3. Resin
4. 3100K White LED Ellipsoidal

Potential Suppliers

Fibre Glast Developments Corp

385 Carr Drive
Brookville, OH 45309
Phone 800-838-8984
Fax 937-833-6555
www.fibreglast.com

Jakob Rope Systems

Dorfstrasse 34
CH-3555 Trubschachen
Switzerland
Phone +41 (0)34-495-1010
www.jakob.com

Stage Lighting Store

4827 Philips Hwy
Suite 2
Jacksonville, FL 32207
Phone 904-683-5553
www.stagelightingstore.com

McMaster-Carr Supply Co

9630 Norwalk Blvd.
Santa Fe Springs, CA 90670
Phone 562-692-5911
www.mcmaster.com

San Diego Airport Artwork – Preliminary Maintenance and Safety Plan

Routine Maintenance

In the event that the installation acquire dirt or dust, we recommend using pressurized sprayer to clean when necessary.



It is also recommended that the artwork is cleaned with a pressure washer at least twice per year (see pictures below). Mild soap can be used and then followed by a water rinse, then allowed to air dry.

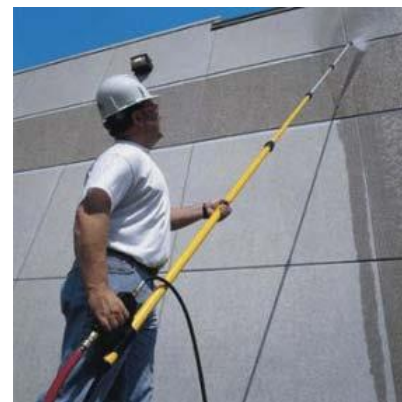

In the event of cable or plastic components breaking, contact the Artists.

Long Term Maintenance

Stainless Steel and plastic provides several decades of corrosion protection in many environments. Stainless Steel is naturally resistant to oxidation, and plastic can withstand most environments. The cables should therefore require no long-term maintenance due to corrosion and weathering.

Safety

In the event of physical interaction, cables and chains with high tensile strengths will be selected to prevent any breakages of the strands which may result in injuries to the public.

San Diego Airport Artwork – Preliminary Timeline

Phase 1: Design Development

Approximately 10 weeks

- Establish Stakeholder Requirements
- Site/Data Collection and Research
- Establish Impact Facilities
- Establish Inter-Team Workflow and Deliverables
- Design Development and Documents
- Stakeholder Design Presentation and Meetings
- Schematic Structural Engineering
- Finalize Design
- Maintenance and Conservation Requirements and Procedures
- Final Design Approvals

Phase 2: Construction Documents

Approximately 20 weeks

- Order Cable, Carbon Fiber, and Resin
- 50% Construction Documents / Present to Stakeholders
- Structural Engineering Construction Drawings
- 100% Construction Documents / Present to Stakeholders
- Plan Check (if required)
- Permitting and Licensing (if required)
- Process Reports
- Construction Document Revision
- Submit to Stakeholders
- Prepare Bid Set
- Bidding Assistance and Bid Evaluation

Phase 3: Fabrication and Installation

Approximately 30 weeks

- Fabricator Meetings / Coordination / Quality Control
- Programming Coordination
- Material Deliverables
- Finish Samples / Sample Parts
- Deliver Work
- Stakeholder Acceptance / Notice to Proceed
- Installation Schedule Review
- Site Preparation
- Revisions and Change Orders
- Evaluate Change and Cost Proposal
- Staging
- On Site Installation
- Progress Reports
- Record Set
- Notification of Completion
- Stakeholder / City Inspection
- Outline Maintenance Guidelines
- Final Acceptance



ARRIVE, DEPART,
BE INSPIRED.

Item 4: Staff Updates

Lauren Lockhart
Art Program Manager

Chris Chalupsky
Sr. Manager, Art & Community Partnerships

May 3, 2016



Public Art

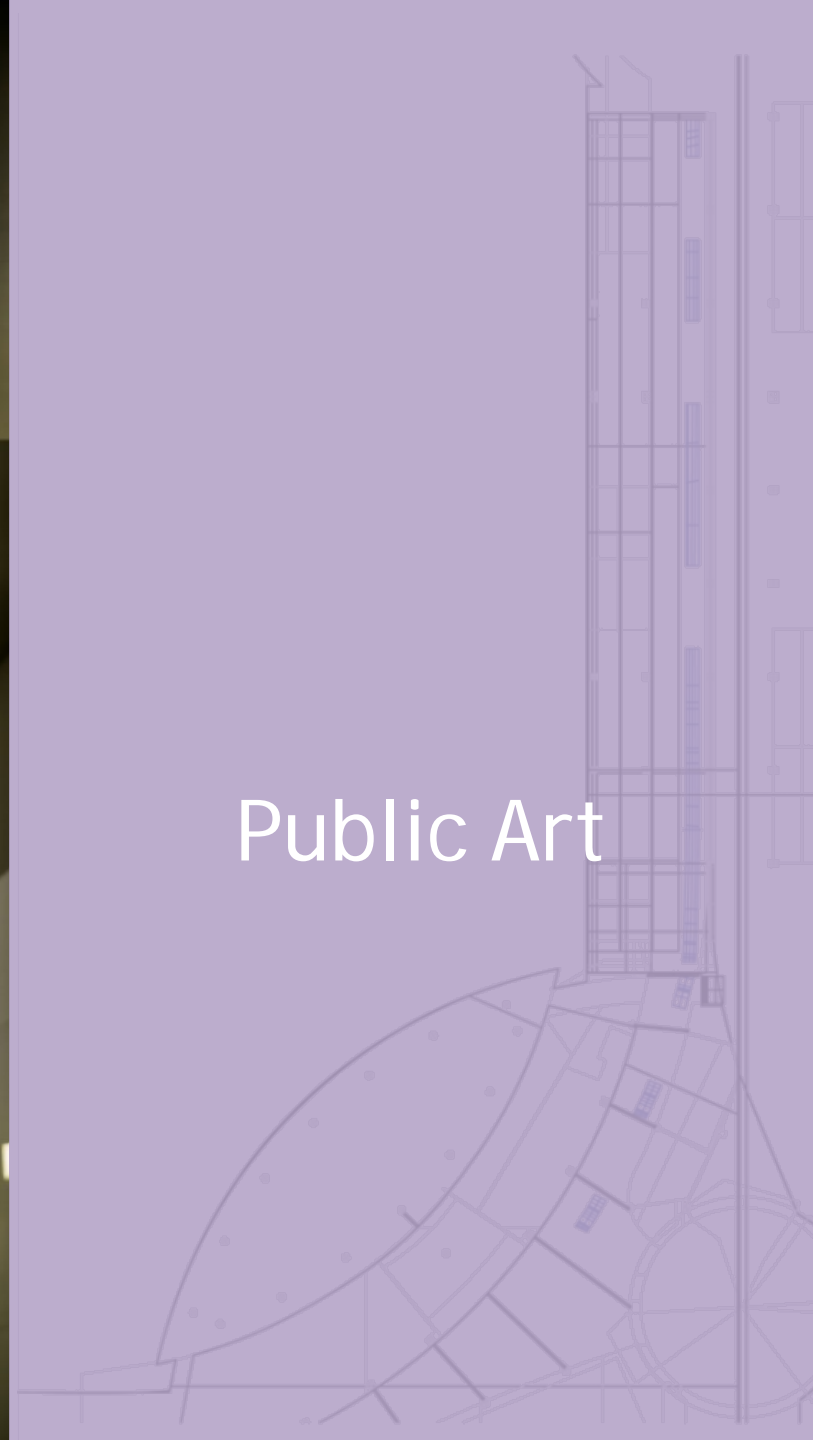



Admiral Boland Way
Fence Public Art Opportunity
(formerly known as the Wind Tunnel Public Art Project)



Temporary Exhibitions Program



Performing Arts Program



Performing Arts Residency Program
Featured Group: Fern Street Circus
First Performance: Wednesday, May 11 from 10 a.m.—12 p.m.



Questions?